

ENROLLED ORDINANCE 180-37

APPROVE TOWN OF GENESEE ORDINANCE NO. 25-4 WHICH AMENDS THE
DISTRICT ZONING MAP OF THE TOWN OF GENESEE
ZONING CODE BY REZONING CERTAIN LANDS LOCATED IN PART OF THE SE ¼ OF
SECTION 10, T6N, R18E, TOWN OF GENESEE; WAUKESHA COUNTY, WISCONSIN,
FROM THE R-1 RESIDENTIAL DISTRICT TO THE
CEM CEMETERY DISTRICT
(RZ161)

WHEREAS, after proper notice was given, a public hearing was held and the subject matter of this Ordinance was approved by the Genesee Town Board on May 27, 2025; and

WHEREAS, the matter was referred to and considered by the Waukesha County Park and Planning Commission, which recommended approval and reported that recommendation to the Land Use, Parks and Environment Committee and the Waukesha County Board of Supervisors, as required by Section 60.62, Wis. Stats.

THE COUNTY BOARD OF SUPERVISORS OF THE COUNTY OF WAUKESHA ORDAINS that Town of Genesee Ordinance No. 25-4 which amends the District Zoning Map for the Town of Genesee Zoning Code, adopted by the Town of Genesee on June 13, 2022, to rezone from the R-1 Residential District to the CEM Cemetery District, certain lands located in part of the SE ¼ of Section 10, T6N, R18E, Town of Genesee, Waukesha County, Wisconsin, as more specifically described in the "Staff Report and Recommendation" and map on file in the office of the Waukesha County Department of Parks and Land Use and made a part of this Ordinance by reference, is hereby approved.

BE IT FURTHER ORDAINED that the Waukesha County Clerk shall file a certified copy of this Ordinance with the Town Clerk of Genesee.

APPROVE TOWN OF GENESEE ORDINANCE NO. 25-4 WHICH AMENDS THE DISTRICT ZONING MAP OF THE
TOWN OF GENESEE ZONING CODE BY REZONING CERTAIN LANDS LOCATED IN PART OF THE SE ¼ OF
SECTION 10, T6N, R18E, TOWN OF GENESEE, WAUKESHA COUNTY, WISCONSIN, FROM THE R-1
RESIDENTIAL DISTRICT TO THE CEM CEMETERY DISTRICT (RZ161)

Presented by:
Land Use, Parks, and Environment Committee

Christine M. Howard, Chair

Wayne Euclide

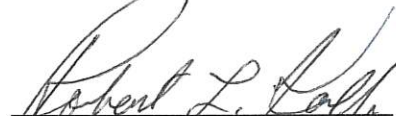

John G. Gscheidmeier

Robert L. Kolb

Absent

Johnny Koremenos

Brian Meier

Steve Styza

The foregoing legislation adopted by the County Board of Supervisors of Waukesha County,
Wisconsin, was presented to the County Executive on:

Date: 09-26-2025, 
Margaret Wartman, County Clerk

The foregoing legislation adopted by the County Board of Supervisors of Waukesha County,
Wisconsin, is hereby:

Approved: X

Vetoed: _____

Date: 10/2/2025, 
Paul Farrow, County Executive

COMMISSION ACTION

The Waukesha County Park and Planning Commission after giving consideration to the subject matter of the Ordinance to amend the District Zoning Map of the Town of Genesee Zoning Code, hereby recommends approval of **RZ161 (Town of Genesee Board St. Paul's Catholic Church)** in accordance with the attached "Staff Report and Recommendation".

PARK AND PLANNING COMMISSION

August 21, 2025

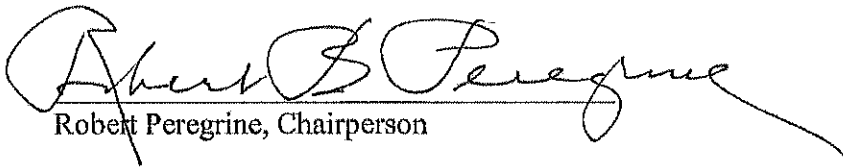
Robert Peregrine, Chairperson

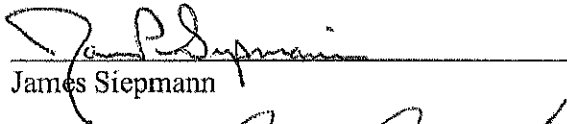
James Siepmann

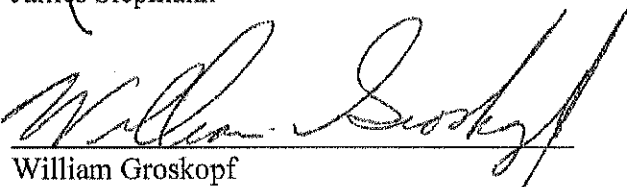
William Groskopf

Gary Szpara

Christine Howard

WAUKESHA COUNTY DEPARTMENT OF PARKS AND LAND USE
STAFF REPORT AND RECOMMENDATION
ZONING MAP AMENDMENT

DATE: August 21, 2025

FILE NO.: RZ161

TAX KEY NO.: GNT 1480.995.001

OWNER: St. Paul's Catholic Church
P.O. Box 95
Genesee Depot, WI 53127

PETITIONER: Town of Genesee Board
Genesee Town Hall
P.O. Box 242
Genesee Depot, WI 53127

LOCATION:
Part of the SE ¼ of Section 10, T6N, R18E, Town of Genesee. More specifically, the property is located at S30 W30032 CTH DE, containing approximately 3.7 acres.

EXISTING ZONING:
R-1 Residential District (town).

PROPOSED ZONING:
CEM Cemetery District.

EXISTING LAND USE:
Cemetery.

PROPOSED LAND USE:
Cemetery.

PUBLIC HEARING DATE:
March 24, 2025.

PUBLIC REACTION:
None.

TOWN PLAN COMMISSION:
On March 24, 2025, the Town Plan Commission unanimously recommended approval of the rezoning request.

TOWN BOARD ACTION:
On May 27, 2025, the Town Board unanimously approved the rezoning request.

COMPLIANCE WITH THE WAUKESHA COUNTY DEVELOPMENT PLAN (CDP) AND THE TOWN OF GENESEE LAND USE PLAN (LUP):

The town and county plan designations for the property are Governmental & Institutional. The proposal to rezone the existing cemetery to the new Cemetery Zoning District is consistent with both plans.

STAFF ANALYSIS:

St. Paul's Cemetery is located on the north side of CTH DE (Sunset Dr.) and to the east of Snowdon Dr. The use pre-dates zoning. In 1961, the cemetery obtained a Conditional Use permit to allow for a three-acre expansion. In 1974, a Conditional Use amendment authorized the sale of a narrow strip of land to a neighboring property to the north. The town has recently revised its zoning ordinance to create a new Cemetery (CEM) zoning district. The town is proposing to rezone two existing cemeteries, including the subject lands, from a residential zoning category to the new zoning district which will alleviate the need for Conditional Use permits as changes to the use or site are made in the future.

STAFF RECOMMENDATION:

Based on the above analysis, the Planning and Zoning Division Staff recommends **approval** of the rezone request. The designation of the existing cemetery in the newly created Cemetery District makes the cemetery use a legal permitted use and will allow subsequent improvements to the property to be made via a Site Plan/Plan of Operation process.

Respectfully submitted,

Jason Fruth

Jason Fruth
Planning & Zoning Manager

Attachments: Town Ordinance No. 25-4
Map

N:\PRKANDLU\Planning and Zoning\Rezoning\PROJECT FILES\Genesee\RZ161 St. Pauls Cath Church\Staff Report and Exhibits\RZ161 St. Pauls Catholic Church Staff Report.docx

STATE OF WISCONSIN

TOWN OF GENESEE

WAUKESHA COUNTY

ORDINANCE 25-4

**An Ordinance to amend the Zoning Map of the Town of Genesee
from R-1 Residential District to CEM Cemetery District on lands located in the
SE ¼ of the SE ¼ of Section 10, T6N, R18E, Town of Genesee,
Waukesha County Wisconsin**

The Town Board of Genesee, Waukesha County, Wisconsin, DOES HEREBY ORDAIN AS FOLLOWS:

Section 1:

The Town of Genesee Zoning Map is hereby amended to change the zoning classification from R-1 Residential District to CEM Cemetery District on the following described parcel of land:

Part of the SE ¼ of the SE ¼ of Section 10, T6N, R18E, Town of Genesee. More specifically, the property is also known as Tax Key No. GNT 1480.995.001 (See Exhibit A).

Section 2: Severability.

The several sections of this ordinance are declared to be severable. If any section or portion thereof shall be declared by a court of competent jurisdiction to be invalid, unlawful or unenforceable, such decision shall apply only to the specific section or portion thereof directly specified in the decision, and shall not affect the validity of any other provisions, sections or portions thereof of the ordinance. The remainder of the ordinance shall remain in full force and effect. Any other ordinances whose terms are in conflict with the provisions of this ordinance are hereby repealed as to those terms that conflict.

Section 3: Effective Date.

This ordinance shall take effect immediately upon passage by Waukesha County and posting or publication as provided by law.

This ordinance passed this 27 day of May, 2025.

BY THE TOWN BOARD OF THE
TOWN OF GENESEE:

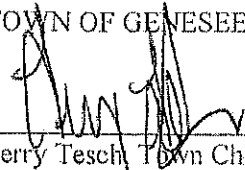
Terry Tesch, Town Chairman

ATTEST:



Meri Majeskie, Town Clerk

Exhibit A

Zoning Map Amendment

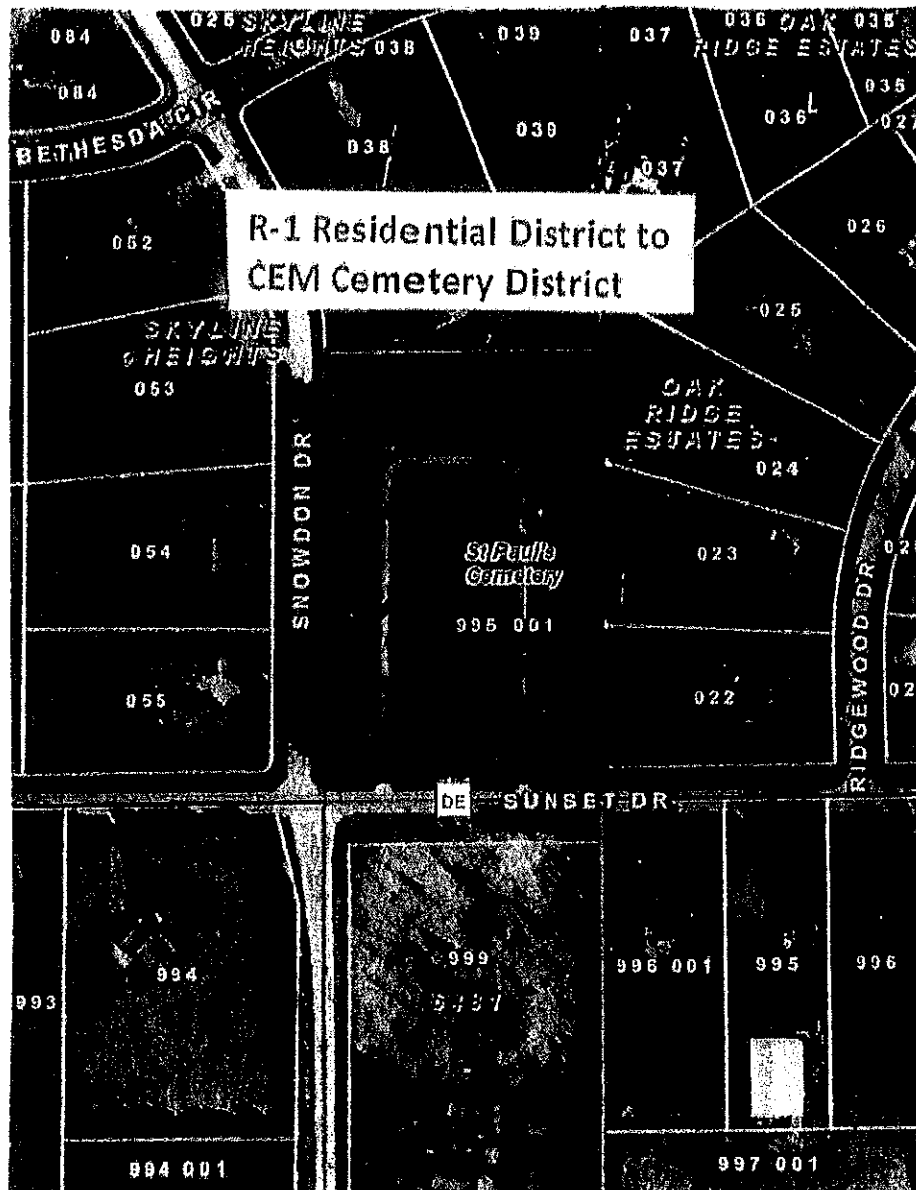
St. Paul's Catholic Church, PO Box 95 Genesee Depot, Wisconsin from the R-1 Residential District to the CEM Cemetery District consistent with the updated Town of Genesee Zoning Code. The property is described as part of the SE ¼ of the SE ¼ of Section 10, T6N, R18E, Town of Genesee. More specifically, the property is located at S30 W30032 CTH DE.

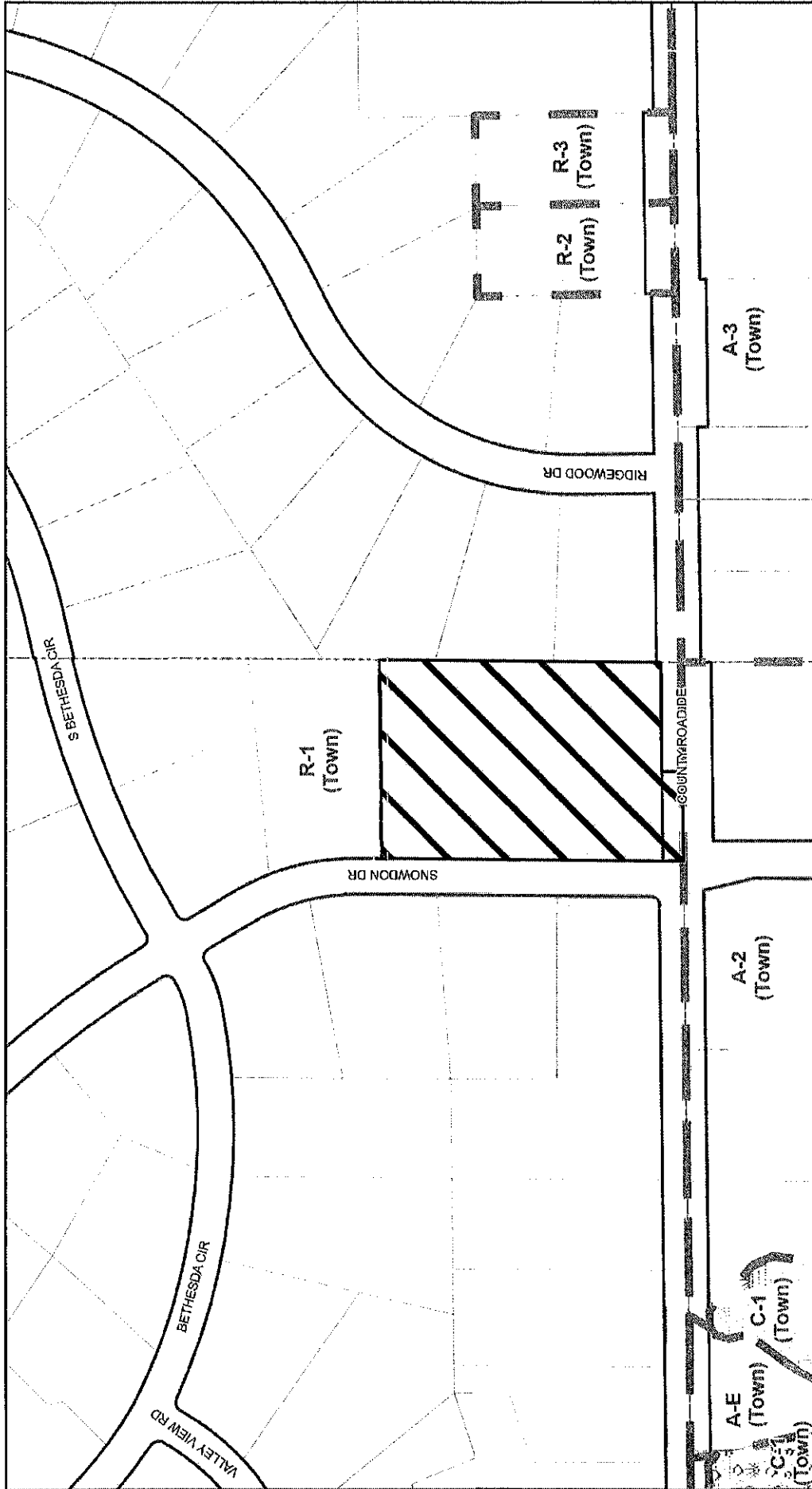



ZONING AMENDMENT

PART OF SE1/4 SEC 10 T6N R18E,
TOWN OF GENESEE



TOWN ZONING CHANGE FROM R-1 RESIDENTIAL DISTRICT TO CEM CEMETERY DISTRICT
EC Environmental Corridor Overlay
C-1 Conservancy Overlay

FILE.....RZ161
DATE OF PLAN COMMISSION.....08/21/25
AREA OF CHANGE.....3.6 ACRES
TAX KEY NUMBER.....GNT 1480995001

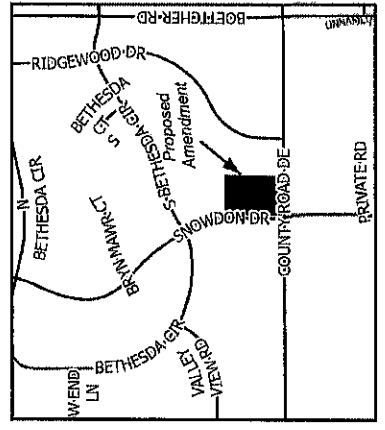

VOTE RESULTS

Consent Agenda

22 AYE 0 NAY 0 ABSTAIN 3 ABSENT

Majority Vote of Members Present

Passed

D1 - Styza	ABSENT	D10 - Thieme	AYE	D19 - Enriquez	AYE
D2 - Euclide	AYE	D11 - Howard	S AYE	D20 - Schellinger	AYE
D3 - Gscheidmeier	AYE	D12 - Wolff	AYE	D21 - Gaughan	AYE
D4 - Batzko	AYE	D13 - Leisemann	AYE	D22 - Szpara	AYE
D5 - Dondlinger	AYE	D14 - Mommaerts	AYE	D23 - Hammitt	M AYE
D6 - Walz	AYE	D15 - Kolb	AYE	D24 - Schroeder	ABSENT
D7 - LaFontain	AYE	D16 - Crowley	AYE	D25 - Johnson	AYE
D8 - Koremenos	AYE	D17 - Meier	ABSENT		
D9 - Heinrich	AYE	D18 - Nelson	AYE		

1 APPROVE TOWN OF GENESEE ORDINANCE NO. 25-4 WHICH AMENDS THE
2 DISTRICT ZONING MAP OF THE TOWN OF GENESEE
3 ZONING CODE BY REZONING CERTAIN LANDS LOCATED IN PART OF THE SE ¼ OF
4 SECTION 10, T6N, R18E, TOWN OF GENESEE, WAUKESHA COUNTY, WISCONSIN,
5 FROM THE R-1 RESIDENTIAL DISTRICT TO THE
6 CEM CEMETERY DISTRICT
7 (RZ161)
8

9 WHEREAS, after proper notice was given, a public hearing was held and the subject matter of
10 this Ordinance was approved by the Genesee Town Board on May 27, 2025; and
11

12 WHEREAS, the matter was referred to and considered by the Waukesha County Park and
13 Planning Commission, which recommended approval and reported that recommendation to the
14 Land Use, Parks and Environment Committee and the Waukesha County Board of Supervisors,
15 as required by Section 60.62, Wis. Stats.
16

17 THE COUNTY BOARD OF SUPERVISORS OF THE COUNTY OF WAUKESHA ORDAINS
18 that Town of Genesee Ordinance No. 25-4 which amends the District Zoning Map for the Town
19 of Genesee Zoning Code, adopted by the Town of Genesee on June 13, 2022, to rezone from the
20 R-1 Residential District to the CEM Cemetery District, certain lands located in part of the SE ¼
21 of Section 10, T6N, R18E, Town of Genesee, Waukesha County, Wisconsin, as more
22 specifically described in the "Staff Report and Recommendation" and map on file in the office of
23 the Waukesha County Department of Parks and Land Use and made a part of this Ordinance by
24 reference, is hereby approved.
25

26 BE IT FURTHER ORDAINED that the Waukesha County Clerk shall file a certified copy of
27 this Ordinance with the Town Clerk of Genesee.