



# PROJECT UPDATE



Waukesha County, in partnership with the Wisconsin Department of Transportation (WisDOT), is reconstructing approximately 1.3 miles of Moorland Road (County O) from National Avenue (County ES) to Cleveland Avenue (County D) in the City of New Berlin. The following work is scheduled as part of this project.

## Beginning the week of April 20, 2026:

Work is scheduled to resume on Moorland Road between National Avenue (County ES) and Cleveland Avenue (County D).

Crews are scheduled to complete median sidewalk, curbing, permanent pavement markings and final landscape restoration.

All work is anticipated to be completed by late spring.

## Traffic Impacts

The inside lanes of northbound and southbound Moorland Road are scheduled to close for approximately two months.

The speed limit on Moorland Road will be reduced to 25 mph in the work zone.

*Access to residences and businesses will be maintained.*

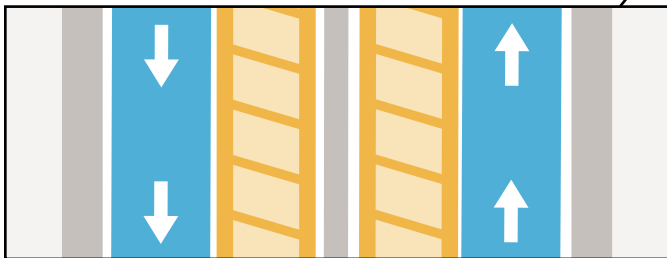
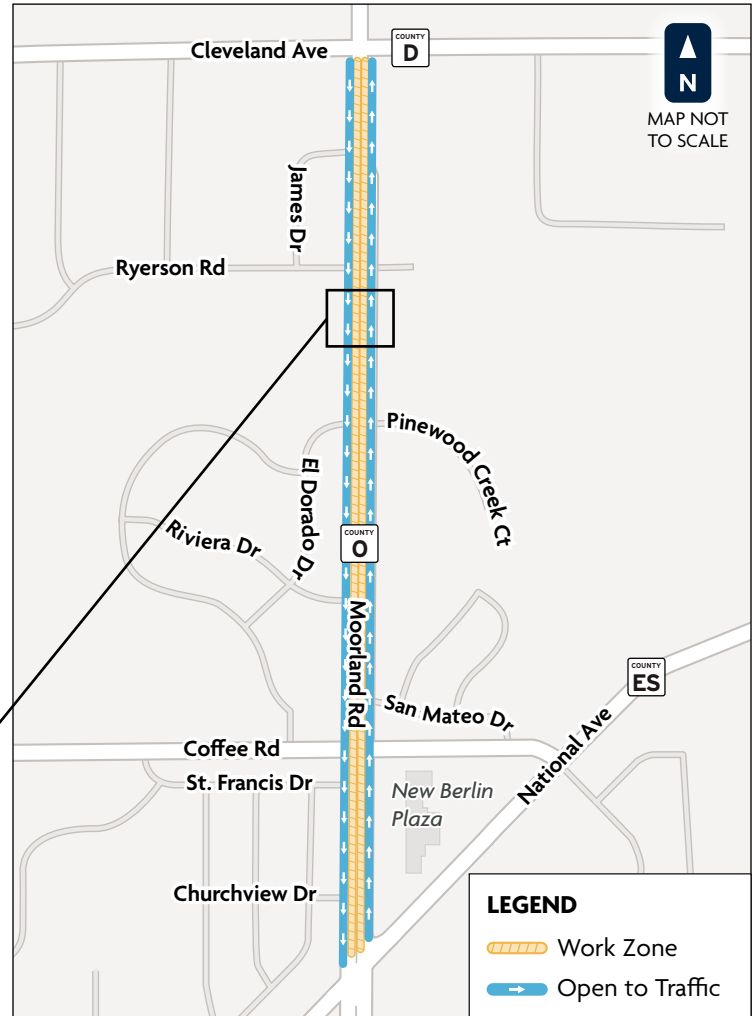

**All work is weather dependent and subject to change.**



## LEARN MORE

Visit the project website and subscribe for updates.  
[tinyurl.com/MoorlandRd](https://tinyurl.com/MoorlandRd)

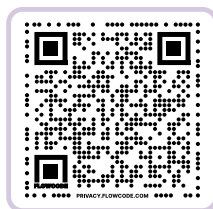

## PROJECT CONTACT

Public Involvement Team

✉ [ConnectSE@devorpr.com](mailto:ConnectSE@devorpr.com)

☎ (920) 204-1070

*The project team thanks you for your patience and cooperation throughout this project!*

Waukesha County, in partnership with the Wisconsin Department of Transportation (WisDOT), is reconstructing approximately 1.3 miles of Moorland Road (County O) from National Avenue (County ES) to Cleveland Avenue (County D) in the City of New Berlin. The following work is scheduled as part of this project.

## The Moorland Road reconstruction project is scheduled to pause for winter and resume in early spring 2026.

### The following work was completed in the 2025 construction season:

- Removed the existing roadway
- Refurbished all storm sewers
- Completed maintenance to the box culvert near Ryerson Road
- Repaved the roadway with new concrete

During winter, Moorland Road will return to a four-lane roadway.

Short-term lane closures may occur during non-peak hours.

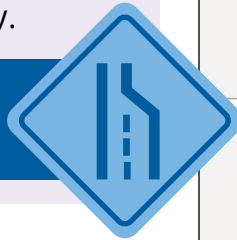

### Work scheduled for spring 2026 includes:

- Sidewalk completion
- Median and landscape restoration
- Permanent pavement markings
- Traffic signal installation



## LEARN MORE

Visit the project website and subscribe for updates.  
[tinyurl.com/MoorlandRd](https://tinyurl.com/MoorlandRd)

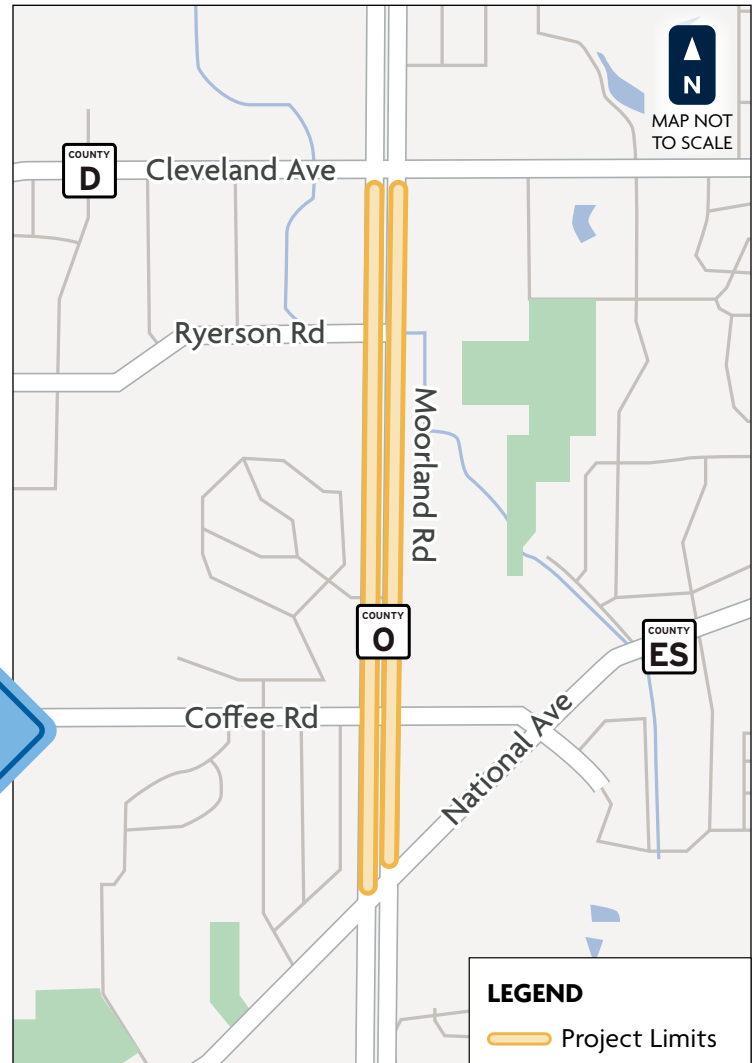

All work is weather dependent and subject to change.

## PROJECT CONTACT

Public Involvement Team

 [ConnectSE@devorpr.com](mailto:ConnectSE@devorpr.com)

 (920) 204-1070

The project team thanks you for your patience and cooperation throughout this project!





# PROJECT UPDATE



Waukesha County, in partnership with the Wisconsin Department of Transportation (WisDOT), is reconstructing approximately 1.3 miles of Moorland Road (County O) from National Avenue (County ES) to Cleveland Avenue (County D) in the City of New Berlin. The following work is scheduled as part of this project.

## Beginning Wednesday, November 19, 2025:

Southbound traffic on Moorland Road, between National Avenue and Cleveland Avenue, is scheduled to be shifted to the newly reconstructed southbound lanes.

The inside lanes of northbound and southbound Moorland Road will remain closed through early December as crews complete traffic signal installation, storm sewer work, landscape restoration, crossover removal and pavement marking.



Residents with mailboxes along Moorland Road are reminded to reinstall their mailbox posts. **Regular mail delivery is anticipated to resume in early December.**

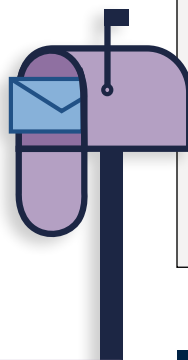

Access to residences and businesses will be maintained.



## LEARN MORE

Visit the project website and subscribe for updates. [tinyurl.com/MoorlandRd](https://tinyurl.com/MoorlandRd)

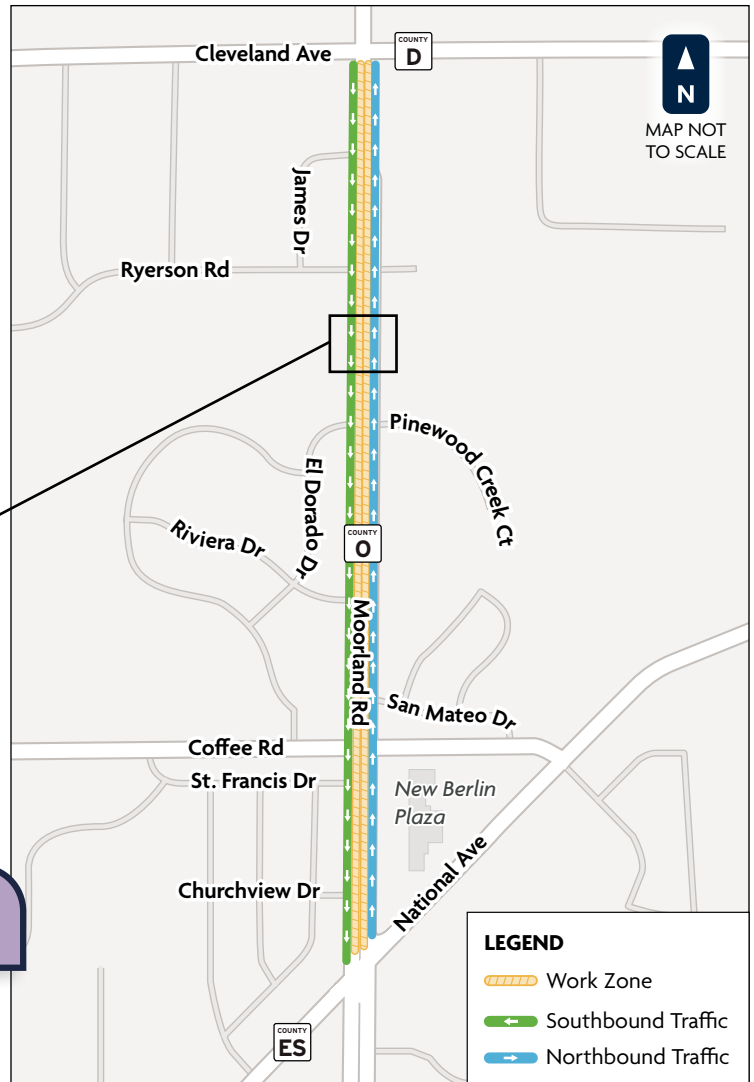
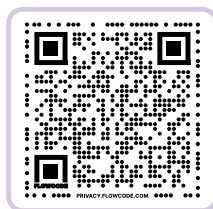

All work is weather dependent and subject to change.

## PROJECT CONTACT

Public Involvement Team

✉ [ConnectSE@devorpr.com](mailto:ConnectSE@devorpr.com)

☎ (920) 204-1070

The project team thanks you for your patience and cooperation throughout this project!



# PROJECT UPDATE



Waukesha County, in partnership with the Wisconsin Department of Transportation (WisDOT), is reconstructing approximately 1.3 miles of Moorland Road (County O) from National Avenue (County ES) to Cleveland Avenue (County D) in the City of New Berlin. The following work is scheduled as part of this project.

## Beginning Monday, November 3, 2025:

Riviera Drive is scheduled to reopen to traffic west of Moorland Road.

Churchview and El Dorado drives are scheduled to close at Moorland Road for intersection reconstruction.

Driveway access is scheduled to be restored by Tuesday, November 4, 2025.

Bidirectional traffic will be maintained in the Moorland Road northbound lanes through late November.

Residents with mailboxes along the west side of Moorland Road may begin reinstalling their mailbox posts the week of November 10. Temporary mailboxes will continue to be used for mail delivery until late November.

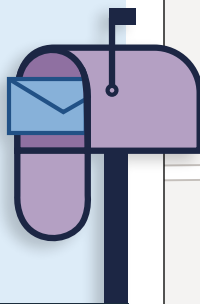

New pavement on southbound Moorland Road

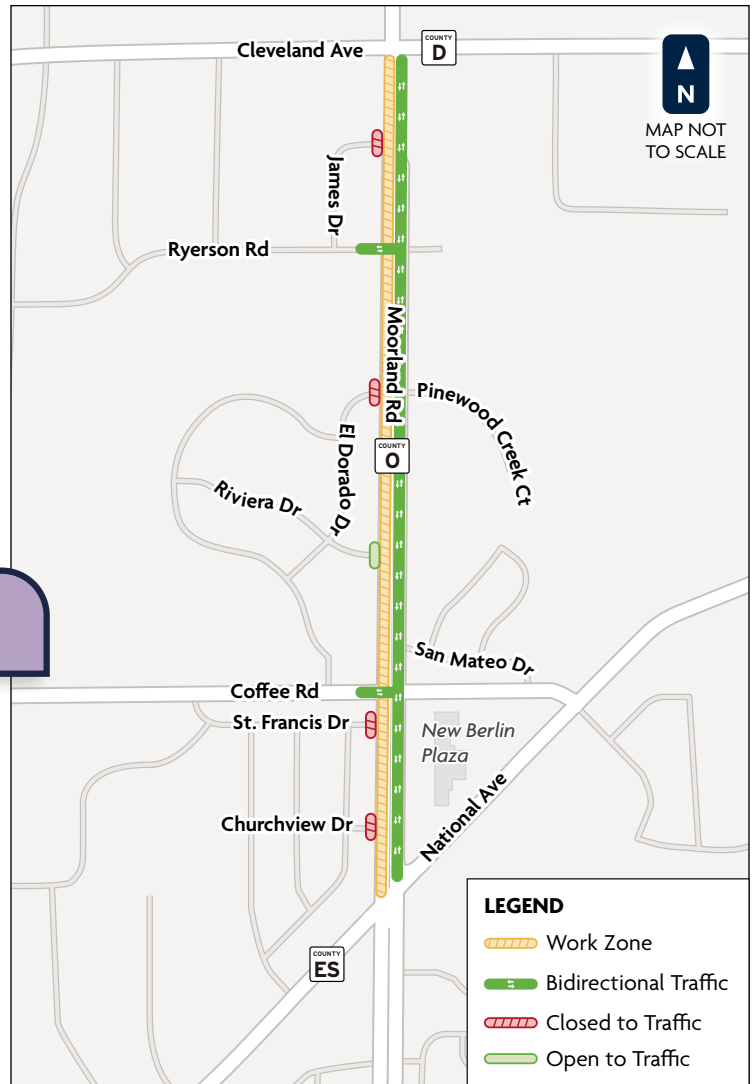

All work is weather dependent and subject to change.



## LEARN MORE

Visit the project website and subscribe for updates. [tinyurl.com/MoorlandRd](https://tinyurl.com/MoorlandRd)

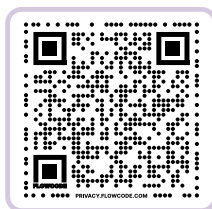

## PROJECT CONTACT

Public Involvement Team

[ConnectSE@devorpr.com](mailto:ConnectSE@devorpr.com)

(920) 204-1070

The project team thanks you for your patience and cooperation throughout this project!



# PROJECT UPDATE



Waukesha County, in partnership with the Wisconsin Department of Transportation (WisDOT), is reconstructing approximately 1.3 miles of Moorland Road (County O) from National Avenue (County ES) to Cleveland Avenue (County D) in the City of New Berlin. The following work is scheduled as part of this project.

### By Tuesday, October 28, 2025:

Coffee Road west of Moorland Road is scheduled to reopen to traffic.

### By Thursday, October 30, 2025:

Ryerson Road west of Moorland Road is scheduled to reopen to traffic.

Access to Moorland Road from Churchview and San Mateo drives will remain limited to right turns only.

St. Francis, Riviera and James drives will remain closed to traffic west of Moorland Road.

Bidirectional traffic will be maintained in the Moorland Road northbound lanes until late fall 2025.

*All work is weather dependent and subject to change.*

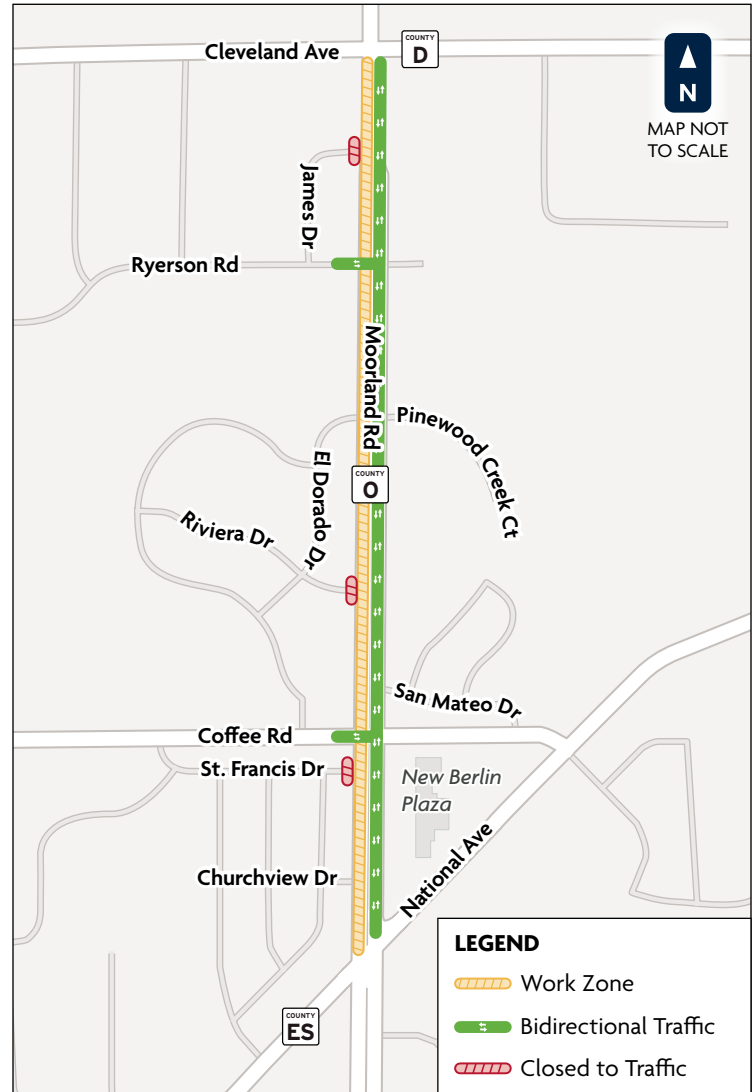

Drivers are reminded to slow down in work zones and stay alert for workers and changing road conditions.

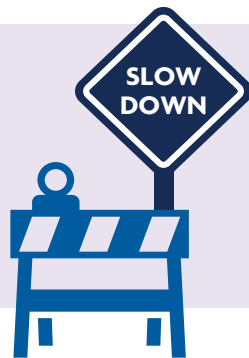

### LEARN MORE

Visit the project website and subscribe for updates. [tinyurl.com/MoorlandRd](https://tinyurl.com/MoorlandRd)

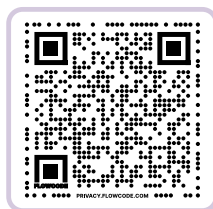

### PROJECT CONTACT

Public Involvement Team

✉ [ConnectSE@devorpr.com](mailto:ConnectSE@devorpr.com)

☎ (920) 204-1070

*The project team thanks you for your patience and cooperation throughout this project!*



# PROJECT UPDATE



Waukesha County, in partnership with the Wisconsin Department of Transportation (WisDOT), is reconstructing approximately 1.3 miles of Moorland Road (County O) from National Avenue (County ES) to Cleveland Avenue (County D) in the City of New Berlin. The following work is scheduled as part of this project.

### Beginning Thursday, October 9, 2025:

Coffee Road west of Moorland Road is scheduled to close for approximately two weeks for concrete removal, grading, electrical work and paving operations.

#### Alternate Route:

- ➔ Motorists traveling on Coffee Road are encouraged to use Calhoun Road and National Avenue to get around the closure

### Beginning Monday, October 13, 2025:

Ryerson Road west of Moorland Road is scheduled to close for approximately two weeks for concrete removal, grading, electrical work and paving operations.

#### Alternate Route:

- ➔ Motorists traveling on Ryerson Road are encouraged to use 160th Street and Cleveland Avenue to get around the closure

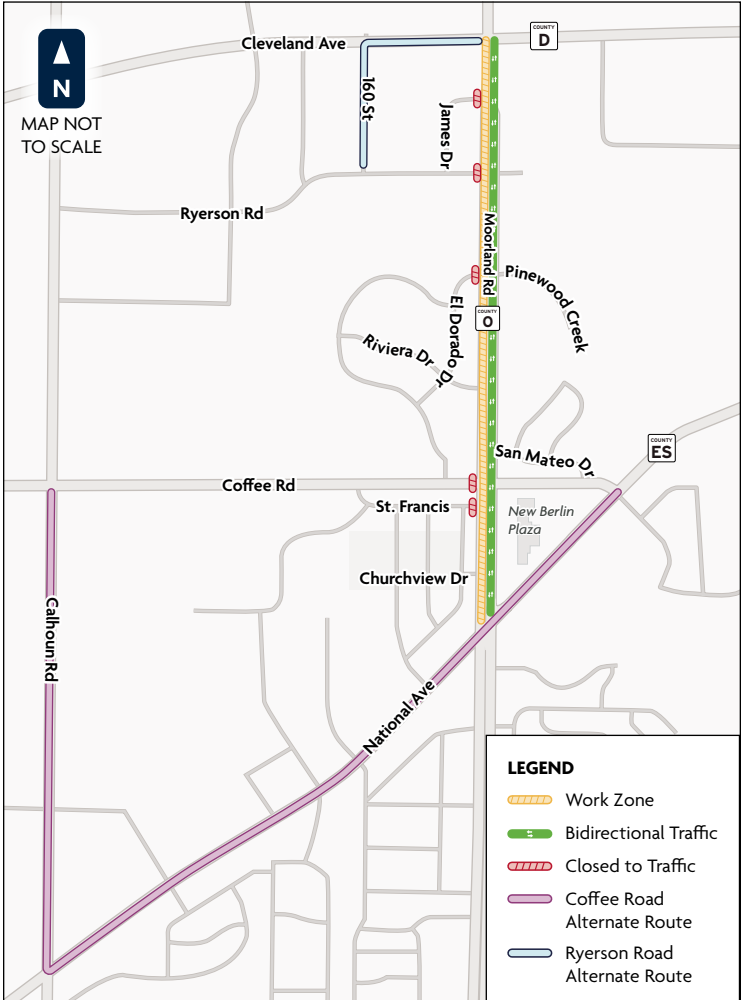

Drivers are reminded to slow down in work zones and stay alert for workers and changing road conditions.

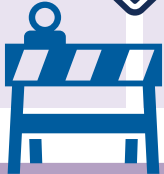

### LEARN MORE

Visit the project website and subscribe for updates.  
[tinyurl.com/MoorlandRd](https://tinyurl.com/MoorlandRd)



*All work is weather dependent and subject to change.*

### PROJECT CONTACT

Public Involvement Team

✉ [ConnectSE@devorpr.com](mailto:ConnectSE@devorpr.com)

☎ (920) 204-1070

*The project team thanks you for your patience and cooperation throughout this project!*



# PROJECT UPDATE



Waukesha County, in partnership with the Wisconsin Department of Transportation (WisDOT), is reconstructing approximately 1.3 miles of Moorland Road (County O) from National Avenue (County ES) to Cleveland Avenue (County D) in the City of New Berlin. The following work is scheduled as part of this project.

### Beginning Monday, October 6, 2025:

El Dorado Drive is scheduled to reopen to traffic on gravel.

Riviera Drive is scheduled to close to traffic west of Moorland Road while crews complete concrete removal, storm sewer work, and grading at the intersection.



*Storm sewer systems collect and transport rainwater, preventing street flooding.*

St. Francis and James drives remain closed to traffic west of Moorland Road.

- ➔ Motorists are encouraged to use National Avenue and Cleveland Avenue for access west of Moorland Road.

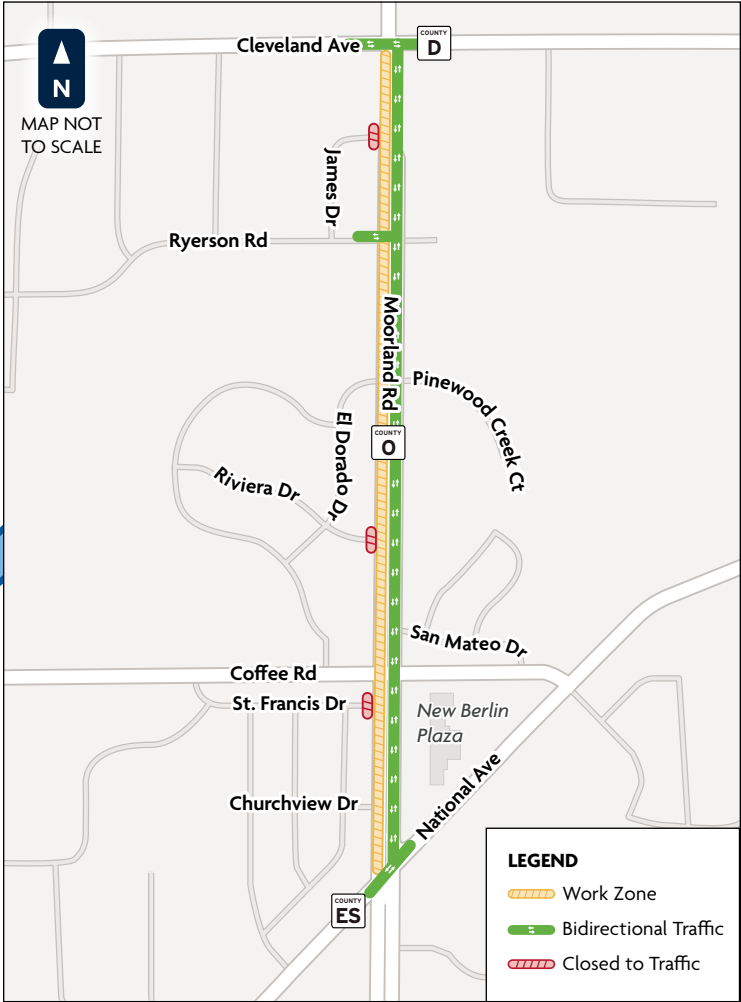

*All work is weather dependent and subject to change.*

Drivers are reminded to slow down in work zones and stay alert for workers and changing road conditions.

### LEARN MORE

Visit the project website and subscribe for updates.  
[tinyurl.com/MoorlandRd](https://tinyurl.com/MoorlandRd)



### PROJECT CONTACT

Public Involvement Team

✉ [ConnectSE@devorpr.com](mailto:ConnectSE@devorpr.com)

☎ (920) 204-1070

*The project team thanks you for your patience and cooperation throughout this project!*



# PROJECT UPDATE



Waukesha County, in partnership with the Wisconsin Department of Transportation (WisDOT), is reconstructing approximately 1.3 miles of Moorland Road (County O) from National Avenue (County ES) to Cleveland Avenue (County D) in the City of New Berlin. The following work is scheduled as part of this project.

## Beginning Wednesday, August 27, 2025:

Bidirectional traffic on Moorland Road is scheduled to shift to the newly paved northbound lanes while crews reconstruct the southbound lanes.

Access to Moorland Road from Churchview and San Mateo drives will be limited to right turns only.

St. Francis, El Dorado and James drives are scheduled to close to traffic west of Moorland Road. Motorists are encouraged to use Coffee Road and Cleveland Avenue for access west of Moorland Road.



Paving on Moorland Road

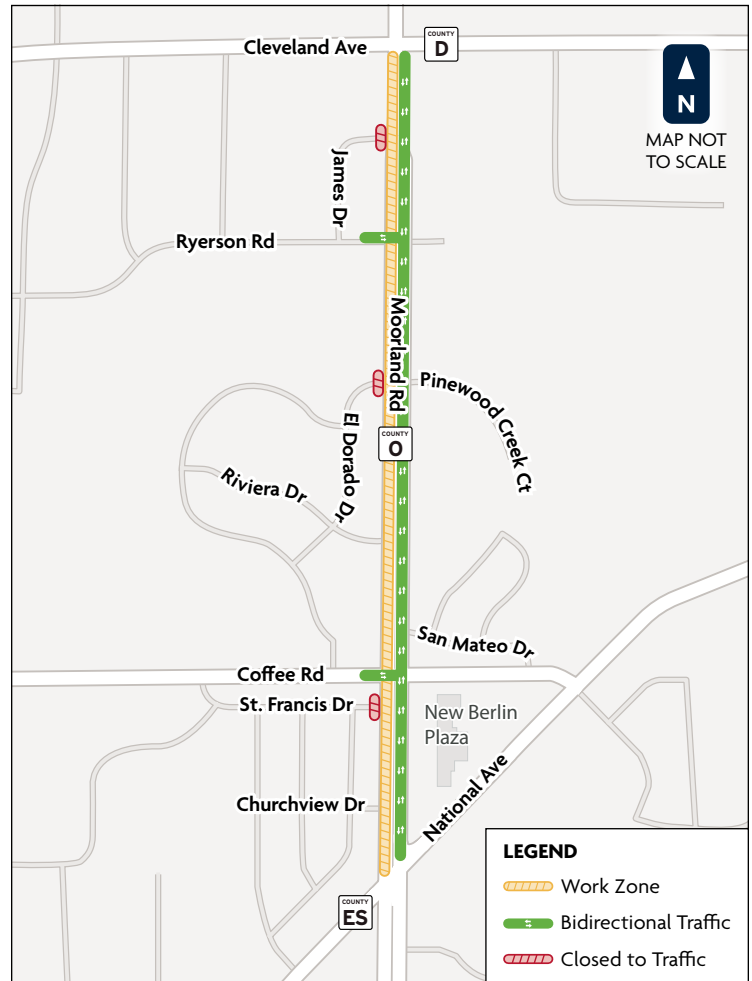

*All work is weather dependent and subject to change.*



### LEARN MORE

Visit the project website and subscribe for updates.  
[tinyurl.com/MoorlandRd](https://tinyurl.com/MoorlandRd)

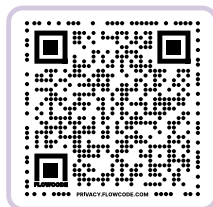

### PROJECT CONTACT

Public Involvement Team

✉ [ConnectSE@devorpr.com](mailto:ConnectSE@devorpr.com)

☎ (920) 204-1070

*The project team thanks you for your patience and cooperation throughout this project!*



# PROJECT UPDATE



Waukesha County, in partnership with the Wisconsin Department of Transportation (WisDOT), is reconstructing approximately 1.3 miles of Moorland Road (County O) from National Avenue (County ES) to Cleveland Avenue (County D) in the City of New Berlin. The following work is scheduled as part of this project.

### Beginning Thursday, July 24, 2025:

Crews are scheduled to begin concrete paving operations on the northbound lanes of Moorland Road.

- Paving will begin at National Avenue and move north to Cleveland Avenue over the next several weeks.
- During paving operations, driveways are scheduled to close for approximately two weeks while crews complete this work. The contractor will notify residents at least 48 hours prior to closing driveway access.
- Residents may resume using their driveway after the concrete cures and crews have removed the cone blocking their driveway.

The intersection of Coffee Road, just east of Moorland Road is scheduled to close for approximately two weeks for concrete removal, grading, storm sewer work, and paving operations. (See map for closure details.)

### Alternate Route:

- ➔ The Moorland Road entrance to the New Berlin Plaza Shopping Center will temporarily reopen for right-in and right-out access during the Coffee Road closure.
- ➔ Motorists traveling on Coffee Road are encouraged to use Moorland Road and National Avenue to get around the closure.

Saw-cutting of pavement joints is scheduled to begin upon completion of paving operations.

- This work is time-sensitive and will continue **OVERNIGHT** as concrete cures.
- **NOISE AND DUST** are associated with this work. Crews will take steps to minimize these effects.

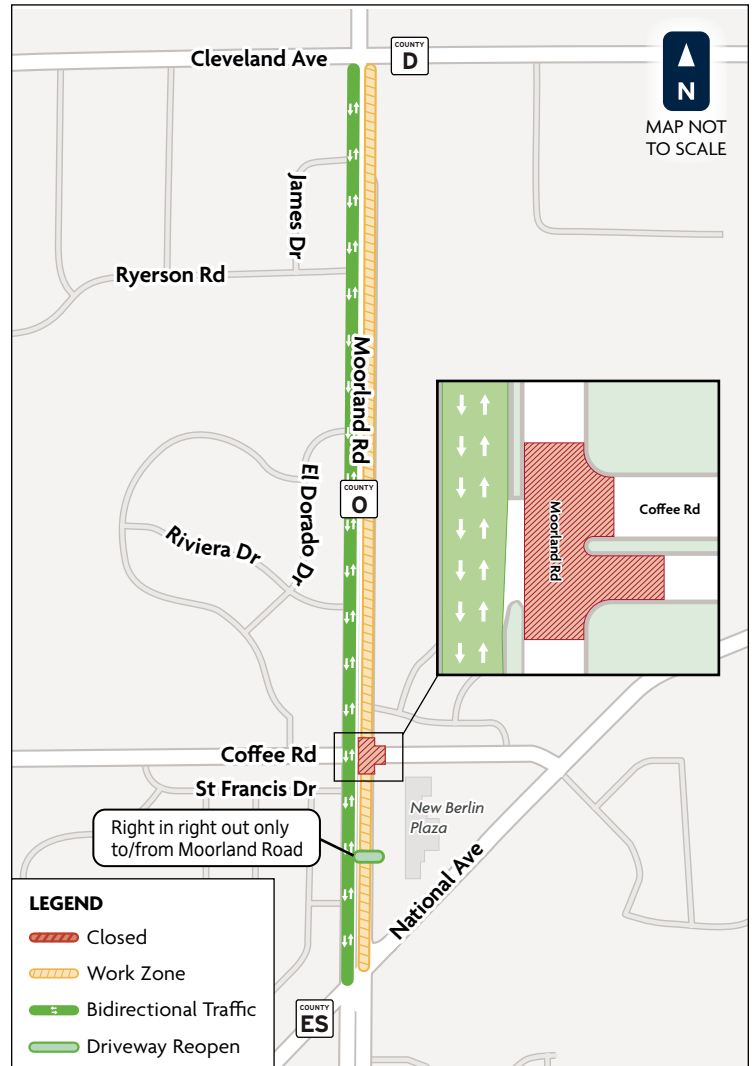

*All work is weather dependent and subject to change.*



### LEARN MORE

Visit the project website and subscribe for updates.  
[tinyurl.com/MoorlandRd](https://tinyurl.com/MoorlandRd)

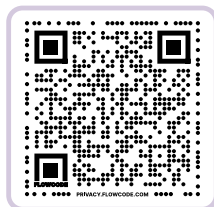

### PROJECT CONTACT

Public Involvement Team

✉ [ConnectSE@devorpr.com](mailto:ConnectSE@devorpr.com)

☎ (920) 204-1070

*The project team thanks you for your patience and cooperation throughout this project!*



# PROJECT UPDATE



Waukesha County, in partnership with the Wisconsin Department of Transportation (WisDOT), is reconstructing approximately 1.3 miles of Moorland Road (County O) from National Avenue (County ES) to Cleveland Avenue (County D) in the City of New Berlin. The following work is scheduled as part of this project.

## Beginning Tuesday, May 27, 2025:

Northbound traffic on Moorland Road is scheduled to be shifted to the southbound lanes between National and Cleveland avenues while crews reconstruct the northbound lanes.

- One lane of traffic will be maintained in each direction throughout the project

Access to Moorland Road from Churchview and St. Francis drives will be limited to right turns only.

## Alternate Route:

San Mateo Drive will be closed to traffic while crews reconstruct the intersection.

- ➔ Motorists are encouraged to use Coffee Road and 153rd Street to get around the closure

Businesses and residents should be aware that noise and dust will be associated with this work. Steps are taken to minimize these effects.

*Access to residences and businesses will be maintained.*

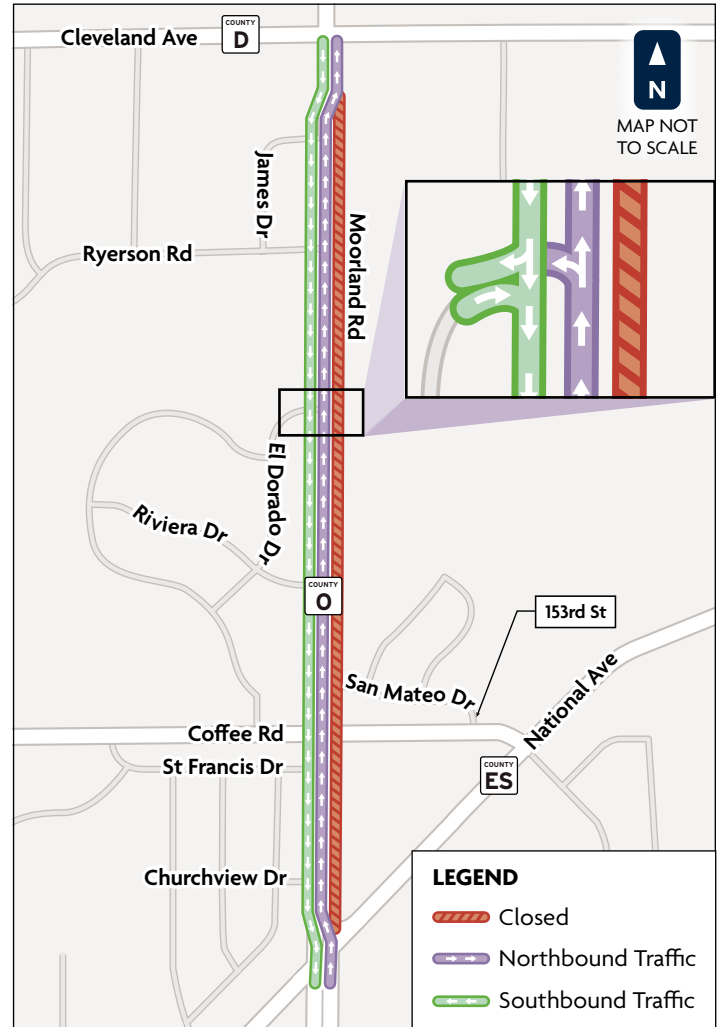

*All work is weather dependent and subject to change.*

Motorists entering the work zone should reduce speed, stay alert, and follow all traffic signs. Watch for workers, equipment, and changing road conditions.



## LEARN MORE

Visit the project website and subscribe for updates.  
[tinyurl.com/MoorlandRd](https://tinyurl.com/MoorlandRd)

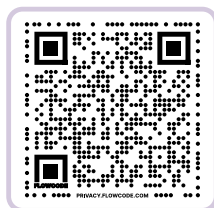

## PROJECT CONTACT

Public Involvement Team

✉ [ConnectSE@devorpr.com](mailto:ConnectSE@devorpr.com)

☎ (920) 204-1070

*The project team thanks you for your patience and cooperation throughout this project!*



# PROJECT OVERVIEW



Waukesha County, in partnership with the Wisconsin Department of Transportation (WisDOT), is scheduled to reconstruct approximately 1.3 miles of Moorland Road (County O) from National Avenue (County ES) to Cleveland Avenue (County D) in the City of New Berlin. Work is starting in mid-May 2025 with an anticipated completion of late fall 2025.

### The following work is planned as part of this project:

- Reconstruction of existing pavement with new concrete pavement and storm sewer improvements
- Intersections within the Moorland Road project limits will be upgraded to improve safety
- All signalized intersections and lighting will be upgraded with modern equipment
- Existing sidewalks and curb ramps will be replaced to conform to Americans with Disabilities Act (ADA) standards
- At least one lane in each direction of Moorland Road will remain open throughout the project

Access to residences and businesses will be maintained.

The speed limit on Moorland Road will be reduced to 25 mph from National Avenue to Cleveland Avenue.

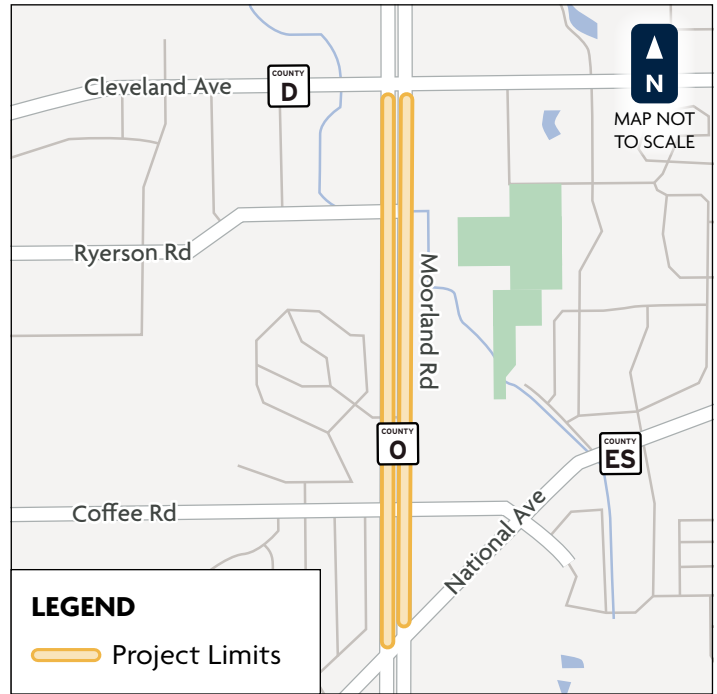



All work is weather dependent and subject to change.

### Traffic Impacts

**Stage 1:** Left lane closures are scheduled while crews construct median crossovers north of National Avenue and north of Ryerson Road.

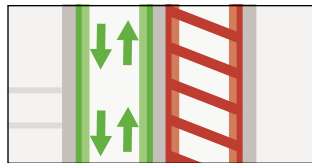
**Stage 2:** Traffic is scheduled to be shifted to a bidirectional format in the southbound lanes while crews reconstruct the northbound lanes.



**Stage 3:** Traffic is scheduled to be shifted to a bidirectional format in the northbound lanes while crews reconstruct the southbound lanes.

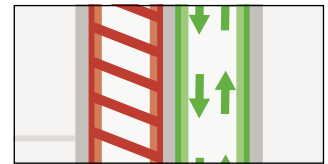

**Stage 4:** Lane closures are scheduled while crews remove the median crossovers and complete landscape restoration.



### LEARN MORE

Visit the project website and subscribe for updates.  
[tinyurl.com/MoorlandRd](https://tinyurl.com/MoorlandRd)

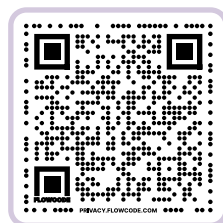

### PROJECT CONTACT

Public Involvement Team

 [ConnectSE@devorpr.com](mailto:ConnectSE@devorpr.com)

 (920) 204-1070

*The project team thanks you for your patience and cooperation throughout this project!*



Moorland Road (County O) Reconstruction Project

# PROJECT OVERVIEW



Waukesha County, in partnership with the Wisconsin Department of Transportation (WisDOT), is scheduled to reconstruct approximately 1.3 miles of Moorland Road (County O) from National Avenue (County ES) to Cleveland Avenue (County D) in the City of New Berlin beginning in spring 2025 with an anticipated completion of late fall 2025.

### The following work is scheduled to take place as part of this project:

- Reconstruction of existing pavement with new concrete pavement and storm sewer improvements.
- Intersections within the Moorland Road project limits will be upgraded to improve safety.
- All signalized intersections and lighting will be upgraded with modern equipment.
- Existing sidewalks and curb ramps will be replaced to conform to Americans with Disabilities Act (ADA) standards.

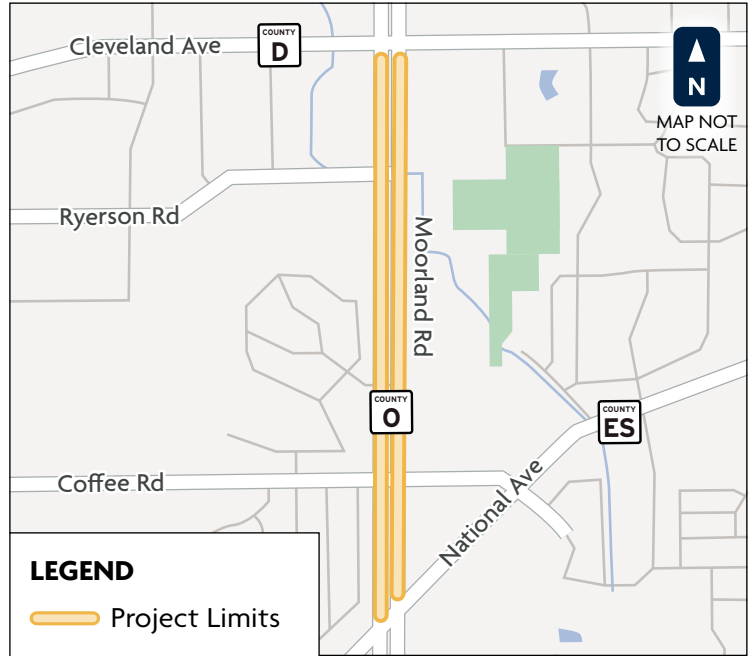

### Traffic Impacts:

- ➔ Northbound traffic is scheduled to be shifted to the southbound lanes in a bidirectional format from spring to mid-summer while crews reconstruct the northbound lanes.
- ➔ Southbound traffic is scheduled to be shifted to the newly constructed northbound lanes in a bidirectional format from mid-summer to late fall while crews reconstruct the southbound lanes.
- ➔ Moorland Road (County O) will remain open with one lane in each direction throughout the project, and a temporary speed limit of 25 miles per hour.



Access to residences and businesses will be maintained.

All work is weather dependent and subject to change.

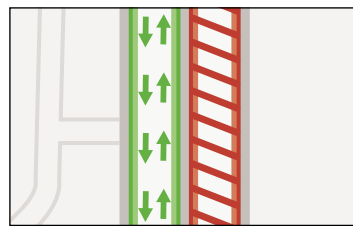

Southbound lanes will be used for bidirectional traffic while the northbound lanes are reconstructed.

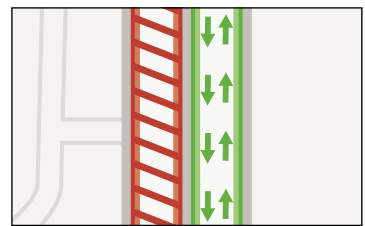

Northbound lanes will be used for bidirectional traffic while the southbound lanes are reconstructed.



### LEARN MORE

Visit the project website and subscribe for updates.  
[tinyurl.com/MoorlandRd](https://tinyurl.com/MoorlandRd)

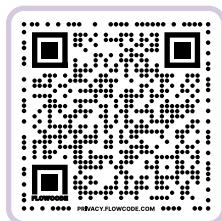

### PROJECT CONTACT

The Public Involvement Team

✉ [ConnectSE@devorpr.com](mailto:ConnectSE@devorpr.com)

☎ (920) 204-1070

The project team thanks you for your patience and cooperation throughout this project!