

ENROLLED ORDINANCE 172-070

LAYING OUT, RELOCATION AND IMPROVEMENT OF COUNTY TRUNK HIGHWAY N  
AT WILTON ROAD, WAUKESHA COUNTY PROJECT I.D. 12-3770(11)

WHEREAS, the County Board of Supervisors of Waukesha County finds that the proper improvement in maintenance of County Trunk Highway N in the Town of Eagle from a point that is 327.44 feet North of and 731.57 feet West of the Southeast corner of Section 8, Town 5 North, Range 17 East in the Town of Eagle, Waukesha County, State of Wisconsin to a point that is 631.67 feet North of and 991.27 feet West of the Southeast corner of Section 8, Town 5 North, Range 17 East, Town of Eagle, Waukesha County, State of Wisconsin requires certain relocation or changes and the acquisition of certain rights of way as shown on the plat marked "Plat of Right of Way Required for C.T.H. N at Wilton Road, Project ID 12-3770(11)".

THE COUNTY BOARD OF SUPERVISORS OF THE COUNTY OF WAUKESHA DOES ORDAIN that the plat marked "Plat of Right of Way Required for C.T.H. N at Wilton Road, Project ID 12-3770(11)" on file in the County Clerk's office is adopted by reference under the authority granted by Section 83.08 and Chapter 32 of the Wisconsin Statutes.

IT IS FURTHER ORDAINED that County Trunk Highway N at Wilton Road is hereby changed or relocated in the Town of Eagle from a point that is 327.44 feet North of and 731.57 feet West of the Southeast corner of Section 8, Town 5 North, Range 17 East in the Town of Eagle, Waukesha County, State of Wisconsin to a point that is 631.67 feet North of and 991.27 feet West of the Southeast corner of Section 8, Town 5 North, Range 17 East, Town of Eagle, Waukesha County, State of Wisconsin in accordance with the plat marked "Plat of Right of Way Required for C.T.H. N at Wilton Road, Project ID 12-3770(11)".

IT IS FURTHER ORDAINED that the County shall acquire those rights of way and other interests as shown on the plat marked "Plat of Right of Way Required for C.T.H. N at Wilton Road, Project ID 12-3770(11)."

<b>D1 - Kolb</b>	<b>AYE</b>	<b>D14 - Wood</b>	<b>AYE</b>
<b>D2 - Zimmermann</b>	<b>AYE</b>	<b>D15 - Mitchell</b>	<b>AYE</b>
<b>D3 - Morris</b>	<b>AYE</b>	<b>D16 - Crowley</b>	<b>AYE</b>
<b>D4 - Batzko</b>	<b>AYE</b>	<b>D17 - Paulson</b>	<b>(2) AYE</b>
<b>D5 - Dondlinger</b>	<b>AYE</b>	<b>D18 - Nelson</b>	<b>AYE</b>
<b>D6 - Walz</b>	<b>AYE</b>	<b>D19 - Cummings</b>	<b>Absent</b>
<b>D7 - Grant</b>	<b>AYE</b>	<b>D20 - Schellinger</b>	<b>AYE</b>
<b>D8 - Michalski</b>	<b>AYE</b>	<b>D21 - Zaborowski</b>	<b>AYE</b>
<b>D9 - Heinrich</b>	<b>(M) AYE</b>	<b>D22 - Wysocki</b>	<b>AYE</b>
<b>D10 - Swan</b>	<b>AYE</b>	<b>D23 - Hammitt</b>	<b>AYE</b>
<b>D11 - Howard</b>	<b>AYE</b>	<b>D24 - Whittow</b>	<b>AYE</b>
<b>D12 - Wolff</b>	<b>AYE</b>	<b>D25 - Johnson</b>	<b>AYE</b>
<b>D13 - Decker</b>	<b>AYE</b>		

172-0-070

Passed (24 Y - 0 N - 1 Absent)

17 YES Needed







LAYING OUT, RELOCATION AND IMPROVEMENT OF COUNTY TRUNK HIGHWAY N  
AT WILTON ROAD, WAUKESHA COUNTY PROJECT I.D. 12-3770(11)

Presented by:  
Public Works Committee

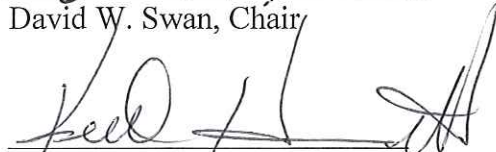
  
David W. Swan, Chair

  
Keith Hammitt

  
Darlene M. Johnson



  
Richard Morris

  
Thomas J. Schellinger

  
Steve Whittow

  
Chuck Wood

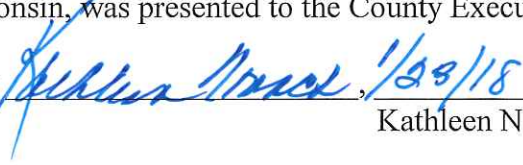
The foregoing legislation adopted by the County Board of Supervisors of Waukesha County, Wisconsin, was presented to the County Executive on:

Date:  1/29/18   
Kathleen Novack, County Clerk

The foregoing legislation adopted by the County Board of Supervisors of Waukesha County, Wisconsin, is hereby:

Approved:   X  

Vetoed: \_\_\_\_\_

Date:   1/29/18  ,   
Paul Farrow, County Executive

R/W PROJECT NUMBER 12-3770(11)	SHEET NUMBER 1	TOTAL SHEETS 2
R/W PROJECT NUMBER 12-3770(11)	PLAT OF RIGHT OF WAY REQUIRED FOR C.T.H. N AT WILTON ROAD	
C.T.H. N CONSTRUCTION PROJECT NUMBER		PROJECT ID WAUKESHA CO.

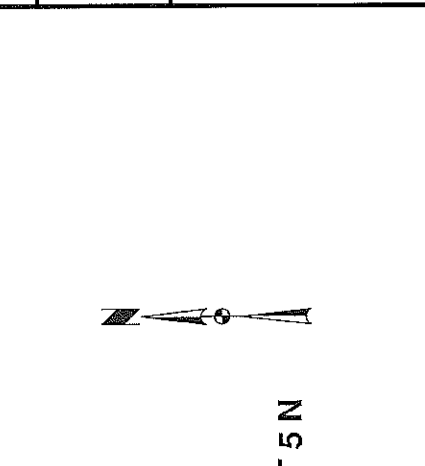

DATE: 11-14-17

APPROVED FOR  
WAUKESHA COUNTY  
DEPARTMENT OF PUBLIC WORKS

DATE: 11-14-17

DATE: 11-15-17

STATE OF WISCONSIN  
DEPARTMENT OF TRANSPORTATION

APPROVED FOR THE DEPARTMENT

DATE: N/A

REVISION DATE

ORIGINAL PLAT PREPARED BY

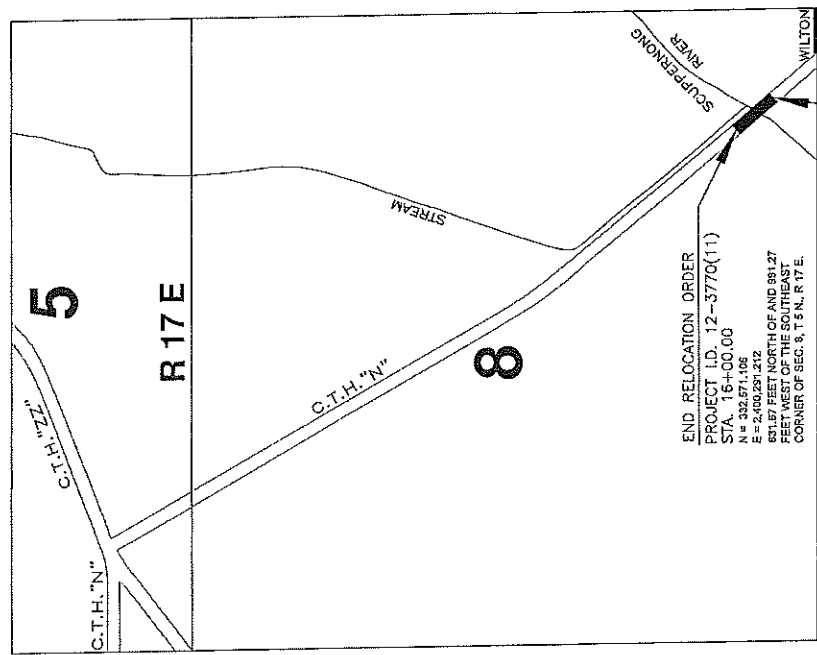

END RELOCATION ORDER  
PROJECT I.D. 12-3770(11)  
STA. 16+00.00  
N = 332,571.108  
E = 2,400,231.212  
531.67 FEET NORTH OF AND 981.27  
FEET WEST OF THE SOUTHEAST  
CORNER OF SEC. 8, T 5 N, R 17 E.

BEGIN RELOCATION ORDER  
PROJECT I.D. 12-3770(11)  
STA. 12+00.00  
N = 332,386.876  
E = 2,400,550.910  
227.44 FEET NORTH OF AND 731.57  
FEET WEST OF THE SOUTHWEST  
CORNER OF SEC. 9, T 5 N, R 17 E.

Scale: 1" = 0.25 MI  
TOTAL NET LENGTH OF CENTERLINE = 0.075 MI. (RURAL)

Layout  
0 0.25 0.50 MI.

### CONVENTIONAL SYMBOLS

SECTION LINE	NON-MONUMENTED
QUARTER LINE	R/W FROM PIN
SIXTEENTH LINE	FOUND IRON PIN
NEW REFERENCE LINE	VALVE (GAS, WATER, ETC.)
NEW R/W LINE	SIGN
EXISTING R/W LINE	OFF-PREMISE SIGN
PROPERTY LINE	COMPOSITE SIGN
LOT, TR & OTHER BOUNDARY LINES	ELECTRIC POLE
CORPORATE LIMITS	TELEPHONE POLE
UNDERGROUND FACILITY (COMMUNICATIONS, ELECTRIC, ETC.)	POTENTIAL (LINE TYPE)
FEASIBILITY STUDY AREA	(TY, TEL, ELEC, ETC.)
TEMPORARY LIMITED EASEMENT AREA	ACCESS CONTROLLED BY ACQUISITION
EASEMENT AREA (HIGHWAY, RESTRICTED DEVELOPMENT)	NO ACCESS (BY STATUTORY AUTHORITY)
TRANSMISSION STRUCTURES	ACCESS RESTRICTED (BY PREVIOUS PROJECT OR CONTROL)
BUILDING	BRIDGE
NATIONAL GEODETIC SURVEY MONUMENT	PARCEL NUMBER
SIXTEENTH CORNER MONUMENT	UTILITY NUMBER

### CONVENTIONAL ABBREVIATIONS

AR	ACCESS RIGHTS
AC	ADDRESS
AH	ALIAS
AM	AND OTHERS
ET AL	BACK
BLK	BLACK
C/L	CENTERLINE
C/S	CORNER
CONG	COUNCIL
CO	COUNTY
CTH	COUNTY TRUNK HIGHWAY
DIST	DISTRICT
DO	DISTRICT OFFICER
COR	CORNER
DOC	DOCUMENT
EA	EASEMENT
EX	EXISTING
GV	GAS VALVE
GR	GRID NORTH
HT	HEIGHT
ID	IDENTIFICATION
LC	LAND CONTRACT
LE	LEFT
LT	LAND TRUST
MON	MONUMENT
NES	NATIONAL GEODETIC SURVEY
NO	NUMBER
OL	OUTLET
P	PAGE
PT	POINT OF TANGENCY
PL	PROPERTY LINE
PLM	PROPERTY LINE MONUMENT
POB	POINT OF BEGINNING
PC	POINT OF CURVATURE

### CURVE DATA

LC	LONG CHORD BEARING
LCS	LONG CHORD STATION
R	RADIUS OF CURVE
A	CENTRAL ANGLE OR DELTA
L	LENGTH OF CURVE
LC	LENGTH OF CHORD
DA	DIRECTION AHEAD
DB	DIRECTION BACK

### CONVENTIONAL UTILITY SYMBOLS

WATER	WATER
GAS	GAS
SEWER	SEWER
OVERHEAD	OVERHEAD
TRANSMISSION LINES	TRANSMISSION LINES
ELECTRIC	ELECTRIC
FIBER OPTIC	FIBER OPTIC
SANITARY SEWER	SANITARY SEWER
STORM SEWER	STORM SEWER

NOTES

HORIZONTAL POSITIONS SHOWN ON THIS PLAT ARE ORIENTED TO THE WISCONSIN STATE PLANE COORDINATE SYSTEM, SOUTH ZONE. ALL PLAT DIMENSIONS ARE IN FEET AND INCHES AND MAY BE CONVERTED TO GRID LENGTH BY MULTIPLYING THE DISTANCE BY THE GRID FACTOR PROVIDED ON THE DETAIL SHEETS.

RIGHT OF WAY BOUNDARIES ARE DEFINED WITH COURSES OF THE PERIMETER OF THE HIGHWAY LANDS REFERENCED TO THE U.S. PUBLIC LAND SURVEY OR OTHER SURVEYS OF PUBLIC RECORD.

THE EXISTING HIGHWAY RIGHT OF WAY SHOWN HEREON IS BASED ON THE SURVEYED CENTERLINE ALIGNMENT OF C.T.H. N ESTABLISHED BY AYRES ASSOCIATES AND OTHER SURVEYS OF PUBLIC RECORD.

DIMENSIONING TO THE RIGHT OF WAY IS MEASURED ALONG AND PERPENDICULAR TO THE CENTERLINE OF CONSTRUCTION.

TOWN

OF

**SCHEDULE OF LANDS & INTERESTS REQUIRED**

PARCEL NO. SHEET NO.	OWNERS	INTEREST REQ'D.	TOTAL AREA ACRES	EASEMENT ACRES REQUIRED T.L.E.	R/W ACRES REQUIRED	TOTAL ACRES REM.
					NEW EXIST. TOTAL	
1	STATE OF WISCONSIN	T.L.E.	22.5/3	0.008	--	22.543
2	GORDON ERICKSON	T.L.E.	369.700	0.006	--	369.700

MAY NOT INCLUDE LANDS OF THE OWNER WHICH ARE NOT CONTIGUOUS TO THE AREA TO BE ACQUIRED. AREAS SHOWN IN THE TOTAL AREA MAY BE APPROXIMATE AND ARE DERIVED FROM TAX ROLLS OR OTHER AVAILABLE SOURCES AND

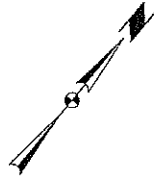

4

4

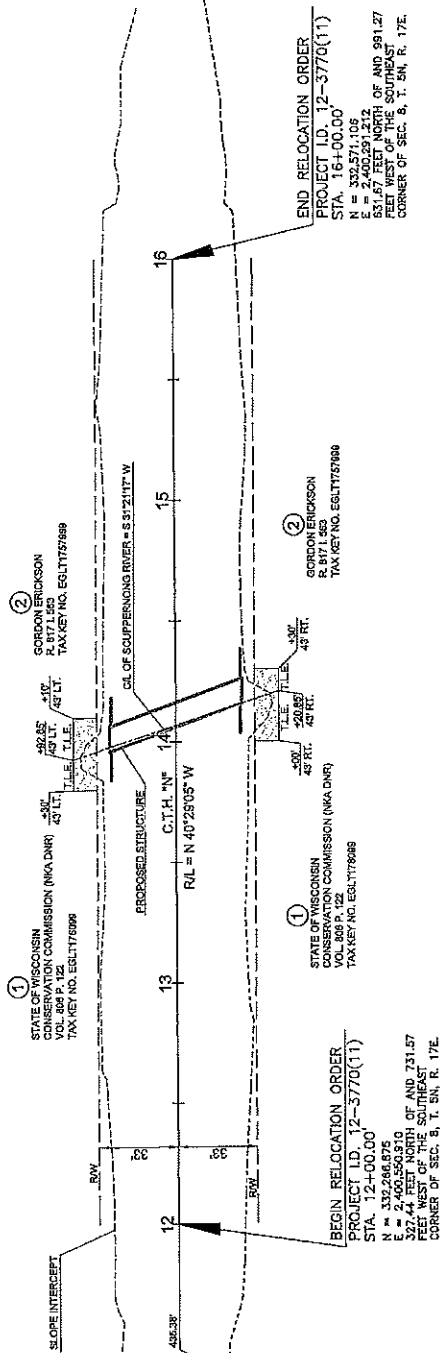

**BEGIN RELOCATION ORDER**  
 PROJECT ID: 12-3770(11)  
 STA. 12+00.00'  
 N = 332,296.875  
 E = 2,400,500.910  
 327.44 FEET NORTH OF CORNER OF SEC. 5, T. 5N, R. 17E.

**END RELOCATION ORDER**  
 PROJECT ID: 12-3770(11)  
 STA. 16+00.00'  
 N = 332,571.105  
 E = 2,400,291.212  
 551.67 FEET NORTH OF CORNER OF SEC. 5, T. 5N, R. 17E.



A CONCRETE MON. WITH A BRASS CAP  
 N = 331950.427  
 E = 2,407982.480

EAGLE

REVISION DATE	DATE: 11-15-2017	HWY: C.T.H. N	CONSTRUCTION PROJECT NO.: 12-3770(11)	SCALE: 1" = 50'
	GRID FACTOR = 0.99992738	COUNTY: WAUKESHA	RAW PROJECT NO.: 12-3770(11)	PLAT SHEET NO.: 4.2
		FILE NUMBER: 142-20-0711	PLAT BY: MAYER, JASON	E

Referred to: PW 3