

Enrolled Ordinance 172-09

MODIFY SPEED ZONE ON COUNTY TRUNK HIGHWAY NN BETWEEN  
PINEHURST DRIVE AND STH 83

WHEREAS, Wisconsin Statutes 349.11 permit local authorities to establish speed zones within certain guidelines, and

WHEREAS, the Waukesha County Department of Public Works finds it appropriate to reduce the speed limit from 40 mph to 35 mph in both directions of County Trunk Highway NN between its intersection with Pinehurst Drive and its intersection with STH 83 in the Town and Village of Mukwonago in response to public inquiries, monitoring driver behavior at the Mukwonago High School vicinity, and a review of vehicle speeds and collisions along this segment of highway.

THE COUNTY BOARD OF SUPERVISORS OF THE COUNTY OF WAUKESHA  
ORDAINS that the speed zone along both directions of County Trunk Highway NN in the Town and Village of Mukwonago is modified to be thirty-five (35) miles per hour between its intersection with Pinehurst Drive and its intersection with STH 83.

BE IT FURTHER ORDAINED that this ordinance rescinds all previous speed restrictions for the above-described portion of the County Trunk Highway System.

Change CTH NN 40 MPH existing posted speed limit to 35 MPH: Pinehurst Dr – STH 83

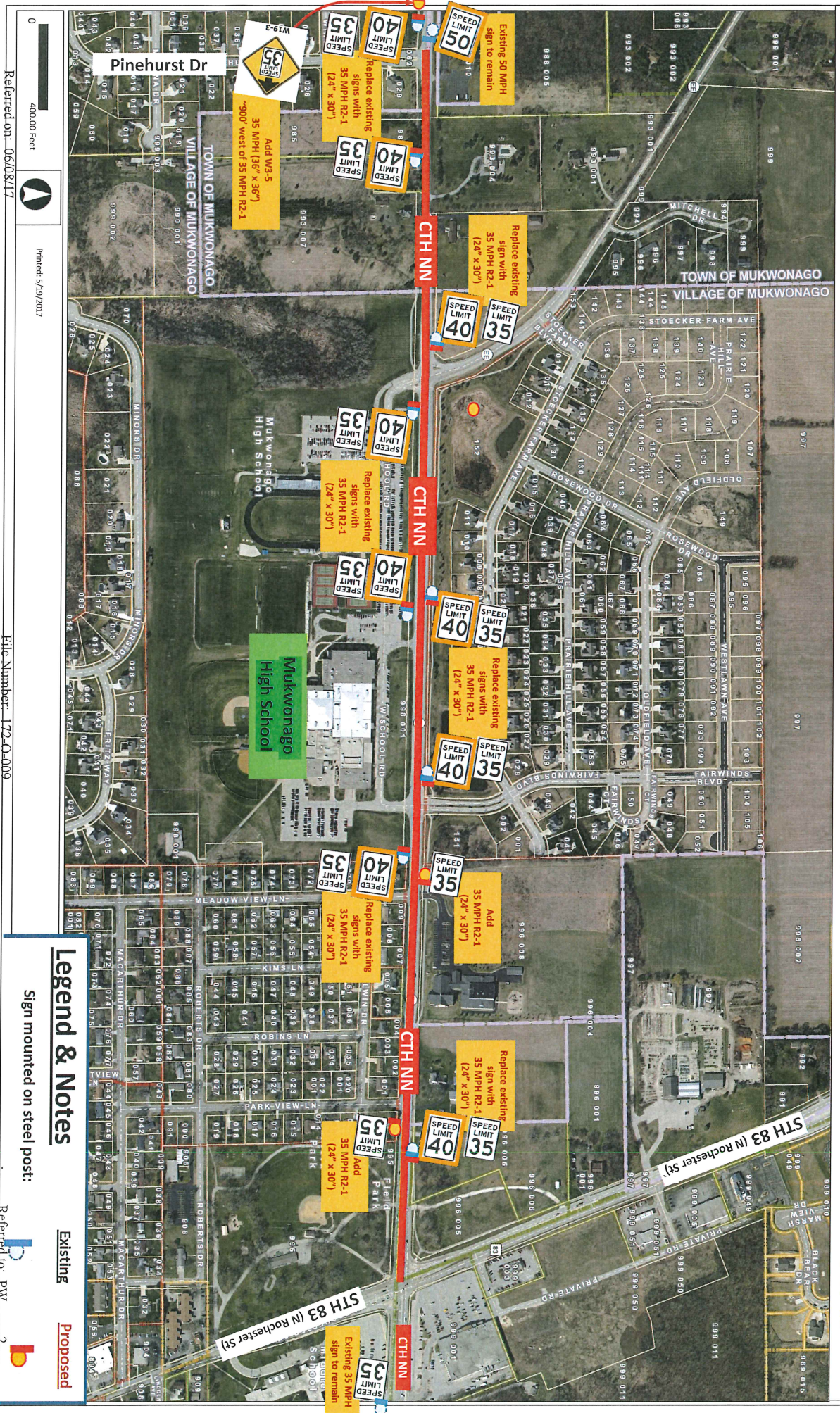

0 400.00 Feet

Printed: 5/19/2017

Referred to: 06/08/17

File Number: 172-O-009

**Legend & Notes**

sign mounted on steel post:

Existing **Proposed**

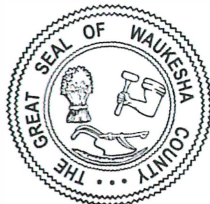

**Waukesha County**  
*Department of Public Works*

**TO:** Waukesha County Board of Supervisors  
**CC:** Allison Bussler, Gary Evans  
**DATE:** May 22, 2017  
**FROM:** Bruce Barnes, P.E., PTOE  
**SUBJECT:** Proposed reduction of CTH NN posted speed limit between Pinehurst Drive and STH 83

Lowering the CTH NN 40-MPH posted speed limit to 35-MPH is recommended between Pinehurst Drive and STH 83. This posted speed limit would become consistent with the CTH NN existing 35-MPH speed limit east of STH 83 along Park View Middle and Clarendon Elementary Schools. The attached exhibit shows the vehicle speeds observed, collision rates, and traffic counts along this 1.1-mile segment of CTH NN having four westbound and five eastbound speed limit signs.

When measured during mid-day at three locations between Pinehurst Drive and STH 83 with no traffic congestion the 85<sup>th</sup>-percentile vehicle speeds were 3-8 MPH faster than the existing 40-MPH speed limit.

However, 77 collisions were reported along CTH NN between Pinehurst Drive and STH 83 over a 5.5-year period (averaging 14/year during Jan 2011-June 2016). This highway segment's crash rate is significantly greater than the statewide average for 2-lane rural highways having similar traffic volumes. Most of these collisions occurred during short periods of traffic congestion prior to and after Mukwonago High School hours. 72% had involved citations for 'inattentive driving' and 34% for 'following too close behind another vehicle'. This segment's traffic condition is distinct from other parts of CTH NN. The 55-MPH speed limit of the CTH NN 4.3-mile long segment between Sprague Road and Pinehurst Drive was reduced recently by 5 MPH to 50 MPH, based on a vehicle speed study and evaluation of collisions. Collisions recorded west of Pinehurst Drive generally involved errant vehicles, 'failure to keep vehicle under control' and 'driving too fast for conditions'.

Reducing the CTH NN posted speed limit between Pinehurst Drive and STH 83 to 35-MPH is recommended as part of the cooperative preparation and implementation of an annual "Student Driving Safety Awareness" program by the Mukwonago Area School District, Mukwonago school teachers, Mukwonago Police, WisDOT's Bureau of Transportation Safety and Waukesha County. The purpose of this new annual program is for improving awareness of driver malpractice typically observed while significant traffic platoon queues develop immediately before and after school hours at the three traffic signals along CTH NN near Mukwonago High School.

If the County Board approves this Ordinance, then this new 35 MPH speed limit would be posted before the start of the upcoming school year.

# CTH NN, Pinehurst Drive to STH 83

Waukesha County Town of Mukwonago

40 MPH Existing Posted Speed Limit (1.1 miles)

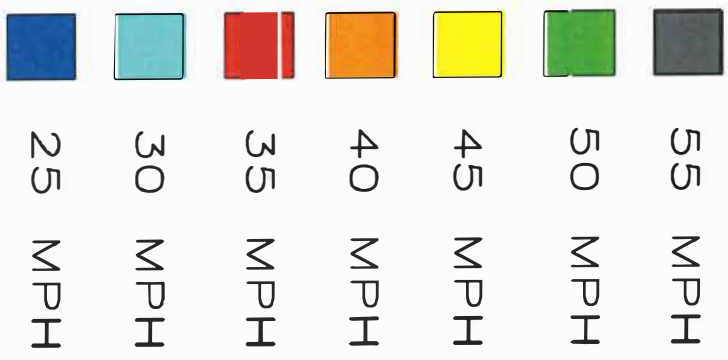
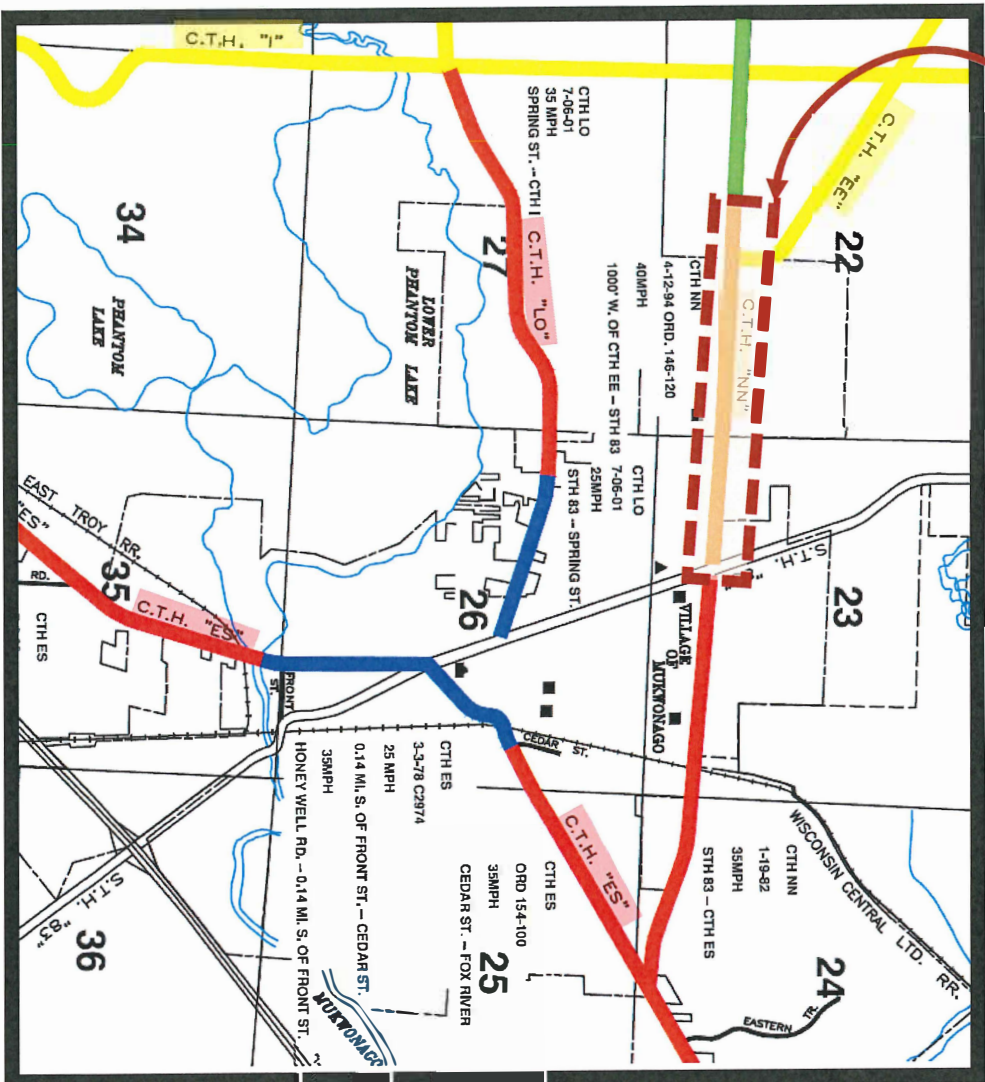

# CTH NN traffic volumes, vehicle speeds and collisions during Jan. 2011 - June 2016 (5.5 years)

CTH NN (NN4: CTH EE - STH 83) 2-way AADT (12,700-14,500): 13,600 vehicles / day

77 crashes during 5.5 years = 14.00 crashes/year

8 KAB crashes during 5.5 years = 1.45 KAB crashes/year

Highway Segment Crash Rate =  $\frac{(\text{collisions/year}) * 100,000,000}{[365 * \text{ADT} * \text{Segment Length}]}$

Highway Segment KAB Crash Rate =  $\frac{(\text{KAB collisions/year}) * 100,000,000}{[365 * \text{ADT} * \text{Segment Length}]}$

256.4 crashes per 100 million vehicle miles travelled (HMVMT)

26.6 KAB crashes per 100 million vehicle miles travelled (HMVMT)

Statewide Avg for 2 la rural, 7000<AADT

88.47

17.75

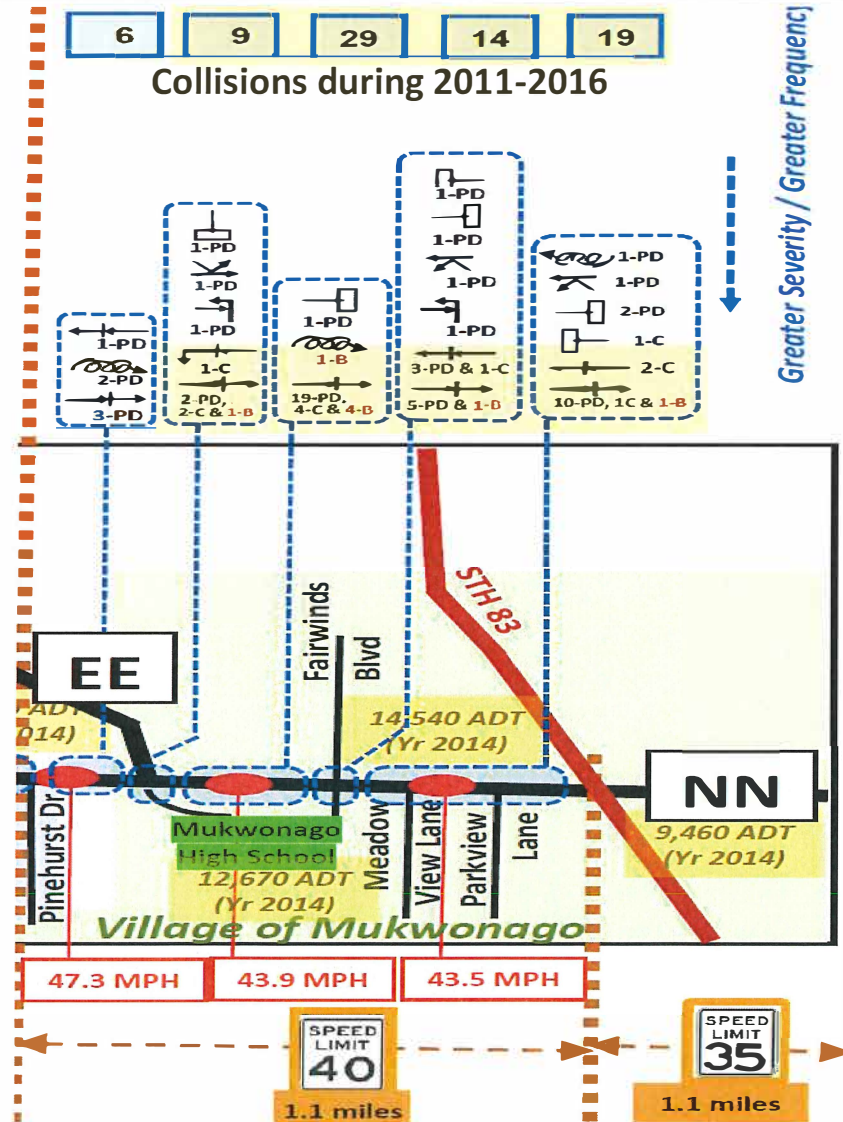
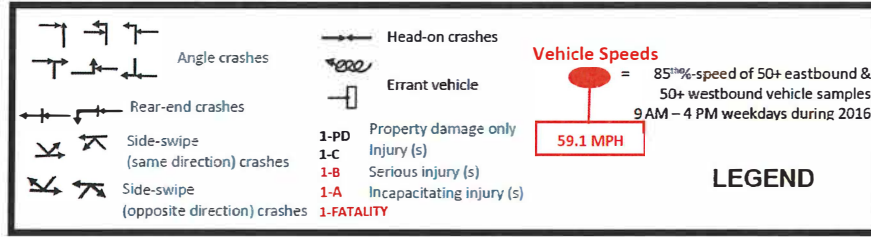



## Student Driving Safety Awareness

- I. Online Moodle Presentation
  - A. Content
    - 1. Various videos/pictures of vehicle crashes due to inattentive driving
    - 2. State and national statistics regarding teen drivers and inattentive driving crashes
    - 3. Crash statistics specific to hwy NN
    - 4. Review of WI state laws regarding inattentive driving/texting, etc
    - 5. Review of safe driving practices- stopping distances, scanning, looking further ahead, etc
    - 6. Consequences of causing a crash due to inattentive driving (legal, financial)
  - B. Within the presentation, there will be “quiz” questions that must be answered correctly before proceeding to the next segment
  - C. Students will access the presentation utilizing their school issued sign-on info
  - D. Student participation is tracked and recorded
- II. Implementation
  - A. Prior to the start of 2017-2018 school year, info will be sent out to students and parents detailing the program
  - B. All students wishing to park in the school lot, will have to successfully complete presentation prior to being able to purchase parking permit
  - C. Private driver’s ed classes that utilize the high school building for their instructions, will have to include the presentation as part of their curriculum as part of their facility use agreement.
  - D. Other driver’s ed businesses that operate outside of the high school, will be contacted and urged as a cooperative effort, to include presentation as part of their curriculum

MODIFY SPEED ZONE ON COUNTY TRUNK HIGHWAY NN  
BETWEEN PINEHURST DRIVE AND STH 83

Presented by:  
Public Works Committee

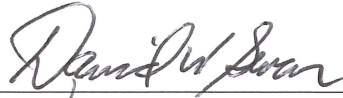
  
David W. Swan, Chair

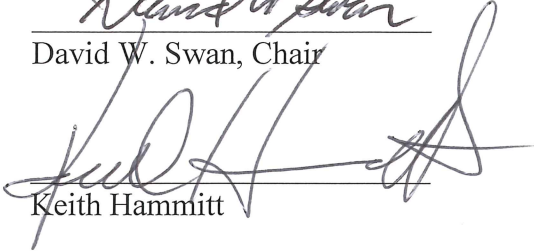
  
Keith Hammitt

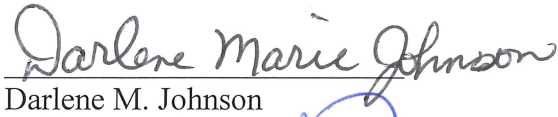
  
Darlene M. Johnson

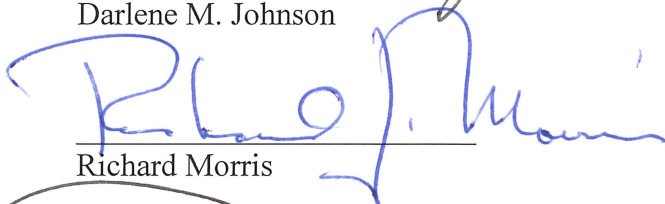
  
Richard Morris

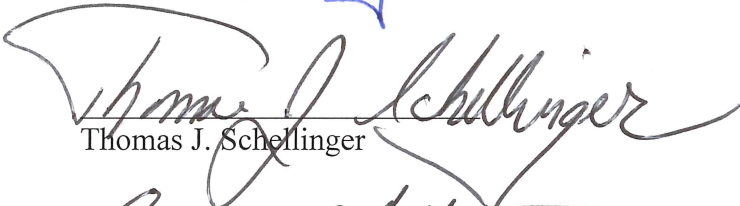
  
Thomas J. Schellinger

  
Steve Whittow

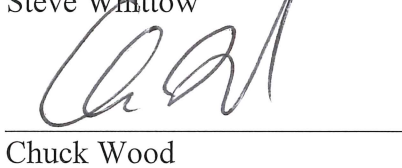
  
Chuck Wood

The foregoing legislation adopted by the County Board of Supervisors of Waukesha County, Wisconsin, was presented to the County Executive on:

Date: 6/29/17,   
Kathleen Novack, County Clerk

The foregoing legislation adopted by the County Board of Supervisors of Waukesha County, Wisconsin, is hereby:

Approved: X

Vetoed: \_\_\_\_\_

Date: 7/7/17,   
Paul Farrow, County Executive



|                       |                |                        |                |
|-----------------------|----------------|------------------------|----------------|
| <b>D1 - Kolb</b>      | <b>AYE</b>     | <b>D14 - Wood</b>      | <b>Absent</b>  |
| <b>2 - Zimmermar</b>  | <b>AYE</b>     | <b>D15 - Mitchell</b>  | <b>AYE</b>     |
| <b>D3 - Morris</b>    | <b>AYE</b>     | <b>D16 - Crowley</b>   | <b>AYE</b>     |
| <b>D4 - Batzko</b>    | <b>AYE</b>     | <b>D17 - Paulson</b>   | <b>AYE</b>     |
| <b>D5 - Dondlinge</b> | <b>Absent</b>  | <b>D18 - Nelson</b>    | <b>AYE</b>     |
| <b>D6 - Walz</b>      | <b>AYE</b>     | <b>D19 - Cumming</b>   | <b>AYE</b>     |
| <b>D7 - Grant</b>     | <b>AYE</b>     | <b>D20 - Schelling</b> | <b>AYE</b>     |
| <b>D8 - Michalski</b> | <b>AYE</b>     | <b>D21 - Zaborows</b>  | <b>AYE</b>     |
| <b>D9 - Heinrich</b>  | <b>AYE</b>     | <b>D22 - Wysocki</b>   | <b>AYE</b>     |
| <b>D10 - Swan</b>     | <b>(M) AYE</b> | <b>D23 - Hammitt</b>   | <b>Absent</b>  |
| <b>D11 - Howard</b>   | <b>AYE</b>     | <b>D24 - Whittow</b>   | <b>AYE</b>     |
| <b>D12 - Wolff</b>    | <b>AYE</b>     | <b>D25 - Johnson</b>   | <b>(2) AYE</b> |
| <b>D13 - Decker</b>   | <b>AYE</b>     |                        |                |

172-0-009

Passed (22 Y - 0 N - 3 Absent)

Majority Vote

>